

REFRIGERATOR MANUFACTURER
Turbo air

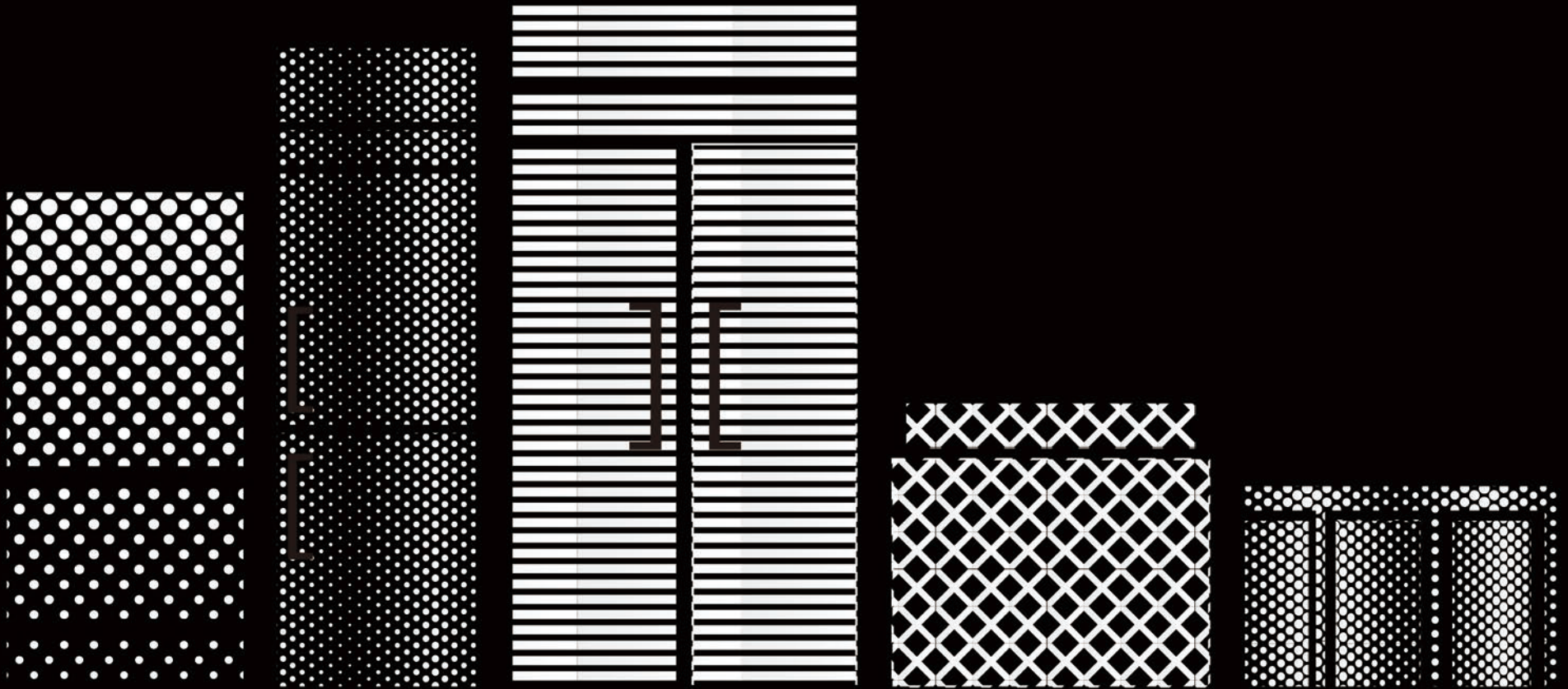

REFRIGERATOR MANUFACTURER
Turbo air

***NO INNOVATION
NO FUTURE***





My 50-Year Journey with Refrigeration

At 13 years old, I began my part-time job to pay for school, which started my 55-year career in refrigeration. I found that I had an aptitude for the work, and more importantly, I enjoyed it. It didn't take long until it wasn't just about raising money for school. I kept at it, and I dropped out of college my freshman year to start my own refrigeration business. I invested my last \$30, taking a risk that paid off. It grew rapidly, and when I was 25 I founded South Korea's first plant to mass-produce commercial refrigerators.

In 1985, I emigrated from South Korea to Los Angeles, where I continued to follow my passions. I opened my business selling and repairing refrigerators. I also constructed restaurants and grocery stores, finding the refrigeration systems and layouts that best fit their needs. Through my combined experiences, I became an expert on the environments which refrigerators operated in and all my competitor's products. As I built my expertise, I noticed that there was little-to-no technological advancement. The products had remained the same over several decades, across all major manufacturers. I knew there was a better way.

I founded Turbo Air with innovation and consumer convenience at the forefront. Turbo Air was the first company to apply digital control in commercial refrigerators, in 1997, and now it's the industry standard. I pioneered the use of automatic fans, temperature control and external monitoring, and indoor illumination for under-counter and salad/sandwich units. I work towards improving Turbo Air products every day, and I continue to lead the charge with my patented Self-Cleaning Condenser. This revolutionary device marks the end of the 100-year-old problem, rooted in ill-maintained condensers.

My innovation goes beyond technology, as I am the trailblazer of innovation in customer service. One of the many precedents I have set in this industry is direct delivery to dealers, with 13 warehouse locations nationwide. Multiple locations ensure damage free delivery within 1-2 days. Also, I utilize in-house technicians, who complete 95% of service calls within 3 business days. I am also the first to implement the MSP (minimum sales price) program in the refrigeration industry to alleviate excessive competition among dealers. I am always looking to improve, not only the products but your experience with customer service. It has been 55 wonderful years, and my journey still continues.

Sincerely,

Brian S. Kim

Brian S. Kim
Chief Engineer & CEO

Global Turbo Air Group

Manufacturing Divisions





Turbo Air in the United States

CALIFORNIA Headquarters

4184 E. Conant St., Long Beach, CA 90808
www.turboairinc.com



Turbo Air China

QINGDAO, CHINA

Commercial Refrigerator Manufacturing Subsidiary
Sales in China, Central-Asia and Europe



Branch/Distribution Locations

HAWAII



179 Sand Island Access Rd. #B
Honolulu, HI 96819

OAKLAND



1617 Whipple Rd. Suite A
Hayward, CA 94544

SEATTLE



2515 142nd Ave. E., Sumner,
WA 98390

NEW JERSEY



10 Basin Dr. Suite 110 Kearny,
NJ 07032

DENVER



3650 Fraser St. Unit C, Aurora,
CO 80011

HOUSTON



4300 N. Sam Houston Pkwy. W.
#410 Houston, TX 77086

DALLAS



1800 S. Great Southwest Pkwy.
Grand Prairie, TX 75051

PITTSBURGH



201 Locust St. Suite B2
Youngwood, PA 15697

CHICAGO



101 E. Crossroads Pkwy. Suite B
Bolingbrook, IL 60440

CINCINNATI



12080 Best Place, Sharonville,
OH 45241

ATLANTA



5345 Buford Highway,
Norcross, GA 30071

MIAMI



2701 SW 145th Ave. Suite 220
Miramar, FL 33027

REFRIGERATOR MANUFACTURER
Turbo air





Why Turbo Air?

Reliability
Energy Efficiency
Elegant Design
Environment Friendly

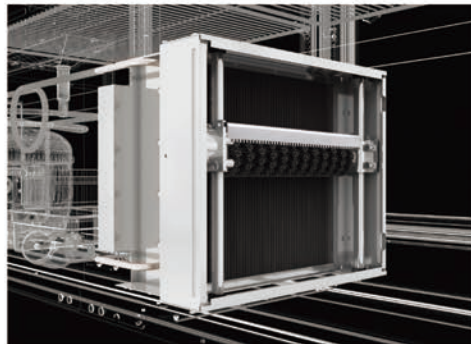
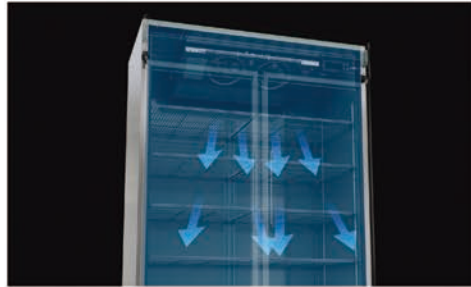

✓ Efficient Refrigeration System

Refrigerators achieve their cooling effect by discharging heat through the condenser. In order to achieve high efficiency, it is important to increase the effectiveness of the condensers, especially in hot & humid places, such as the kitchen. Turbo Air uses its self-produced evaporators and condensers to maximize the efficiency: 10%~15% higher than the industry standard.

✓ Digital Temperature Control System

Digital technology provides precise and constant temperatures throughout the cabinet. This allows food products to remain fresh over an extended period of time.

✓ Condensate Water Cooling System

Unique to Turbo Air products, our anti-corrosion pipes are coated on the surface with a special treatment, allowing the excess condensate waters to cool down the pipe 's hottest area during the refrigerant compression process. This not only saves energy, but also eliminates the need for additional drains, which prevents slippery floors from becoming a safety issue.

✓ Turbo Cooling & Freeze Feature for Faster Chilling

The Turbo Cooling and Freeze function, located on the control panel, allows the compressor to run continuously for up to two hours. When this function is activated, the temperature inside the cabinet quickly decreases and cools drinks, food, and other products much more quickly. An ideal time to use the Turbo Cooling and Freeze function is when the unit is stocked with new products.

✓ LED Lighting Interior Display System

Fluorescent lights emit enormous amount of heat and consume excessive mor e energy. Turbo Air products use LED lights to reduce energy consumption and to extend the unit 's lifespan. They also use optimal light angles to enhance display effects.

✓ Self-cleaning Condenser

Dust can accrue rapidly in areas where refrigeration is installed and used. Dust is drawn through the fan and accumulated. Preventing the condenser from properly releasing heat. This causes the compressor to increase its pressure on refrigerants, increasing the possibility of the compressor breaking down. The 'Self-Cleaning Condenser' cleans the condenser with a rotating brush that moves up and down 2-3 times a day, preventing any dust built-up and making it possible to always maintain the highest efficiency while saving additional energy.

Contents



Reach-In
Refrigerators & Freezers

K-Series

Reach-in Refrigerators & Freezers	11
Reach-in Dual Temp	13
Reach-in Glass door	15

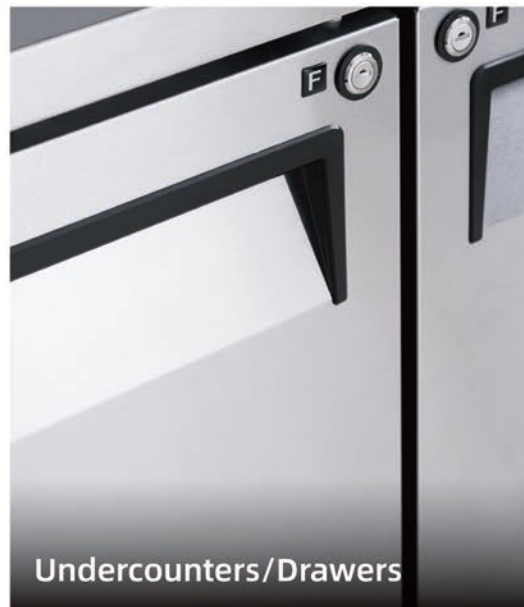

Undercounters/Drawers

K-Series

Undercounter Refrigerators & Freezers	19
Undercounter Glass door	21
Undercounter Dual temp	23
Undercounter Drawers	24

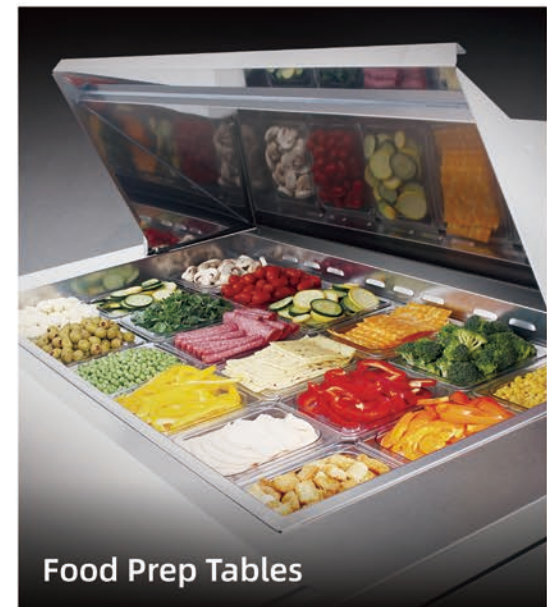

Food Prep Tables

K-Series

Salad Prep Tables	29
-------------------	----

Other Products

Pizza Tables	32
Chef Base Refrigerators	33
Glass Door Merchandiser	36
Back Bar	37
	41



Counter Top & Show Cases

Counter Top Salad Table Sushi case 45

Bakery Cases

Round Bakery Cases 46
 Bakery Cases High 47

Show Cases

Sandwich Cases 50
 Chocolate Cases 58
 Open Cases 60



Baking-Related Products

Dough Freezers/Dough Conditioners 64



Gelato & Icecream Show Cases

Gelato & Icecream Show Cases 66

Specification Sheets

Reach-In Refrigerators & Freezers 68
 Undercounters & Drawers
 Food Prep Tables
 Counter Top & Show Cases
 Baking-Related Products
 Gelato & Icecream Show Cases

A vibrant salad featuring sliced figs, fresh cheese, cucumbers, tomatoes, and leafy greens, served on a wooden table with a red and white checkered napkin and silverware. The image is used as a background for a promotional text overlay.

Reach-In Refrigerators & Freezers

K Series

- ▶ Solid Door
- ▶ Dual Temp
- ▶ Glass Door



LED Interior Lighting



Easy Grip Recessed Door Handle



Highly Efficient Refrigeration System



Patented Self-Cleaning Condenser

- ✓ Fan Control Cooling System
- ✓ Digital Temperature Control & Monitor
- ✓ LED Interior Lighting
- ✓ Easy Grip Recessed Door Handle
- ✓ Drain Water Evaporation System
- ✓ Highly Efficient Refrigeration System
- ✓ Magnetic Door Gasket
- ✓ CFC Free Insulation
- ✓ Using the new ECO-friendly natural refrigerant: R290
- ✓ Patented Self-Cleaning Condenser

Self-Cleaning Condenser

Dirty condenser coils are the main reason for most service calls

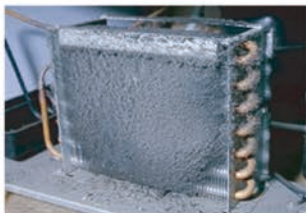

Should be cleaned every 30 to 60 days

- ⚠ Food Stored **Spoiled**
- ⚠ Health Inspection **Failure**
- ⚠ Compressor **Failure**
- ⚠ Energy Consumption **Increase**
- ⚠ Maintenance Fee **Costly**

Solution



Turbo air's patented Self-Cleaning Condenser

How does it work

Turbo air uses a fine mesh filter to catch the dust, while the rotating brush moves up and down 2-3 times a day to remove the excess outward and away from the condenser, effectively preventing dust from accumulating in the first place.



Fine Mesh Filter

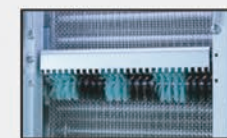

Rotating Brush



Prevent Dust Build up

REACH-IN REFRIGERATORS/FREEZERS

K-Series

NATURAL Refrigerant **N=(HC)**



KR25-1-N (Fridge)

Dimensions	640x860x1926
Capacity	574
Energy consumption	1.57Kw/24Hr

Door Reversible



KR45-2-N (Fridge)

Dimensions	1260x860x1926
Capacity	1215
Energy consumption	2.56Kw/24Hr



KR65-3-N (Fridge)

Dimensions	1900x860x1926
Capacity	1876
Energy consumption	3.84Kw/24Hr

KF25-1-N (Freezer)

Dimensions	640x860x1926
Capacity	574
Energy consumption	4.64Kw/24Hr

Door Reversible

KF45-2-N (Freezer)

Dimensions	1260x860x1926
Capacity	1215
Energy consumption	6.74Kw/24Hr

KF65-3-N (Freezer)

Dimensions	1900x860x1926
Capacity	1876
Energy consumption	12.82Kw/24Hr

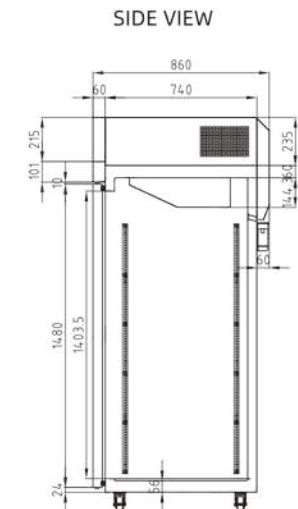
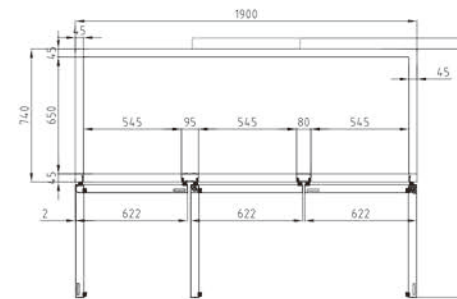
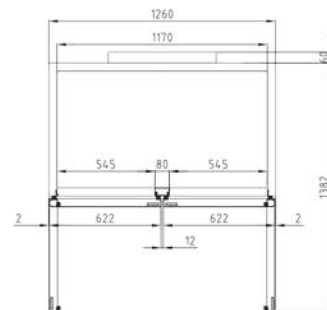
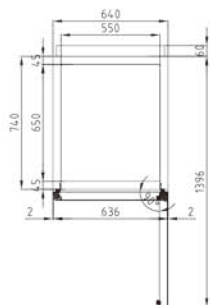

R: 1°C~8°C
F: -21°C~-12°C
FAN COOLING
WxDxH (mm)

NATURAL Refrigerant
N=(HC)



KR25-2-N (Fridge)

Dimensions	640x860x1926
Capacity	572
Energy consumption	1.65Kw/24Hr

KF25-2-N (Freezer)

Dimensions	640x860x1926
Capacity	572
Energy consumption	4.74Kw/24Hr

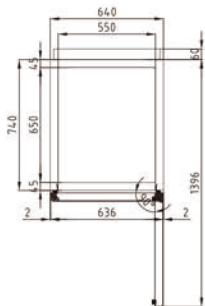

KR45-4-N (Fridge)

Dimensions	1260x860x1926
Capacity	1210
Energy consumption	2.63Kw/24Hr

KF45-4-N (Freezer)

Dimensions	1260x860x1926
Capacity	1210
Energy consumption	7.11Kw/24Hr

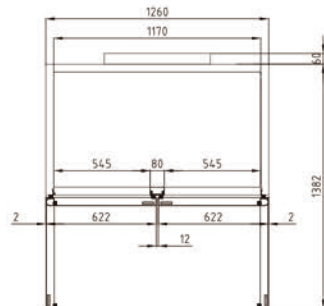

KR65-6-N (Fridge)

Dimensions	1900x860x1926
Capacity	1868
Energy consumption	3.84Kw/24Hr

KF65-6-N (Freezer)

Dimensions	1900x860x1926
Capacity	1868
Energy consumption	12.82Kw/24Hr

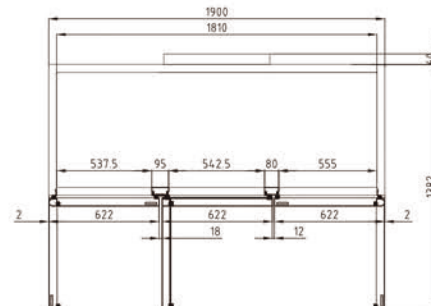

SIDE VIEW

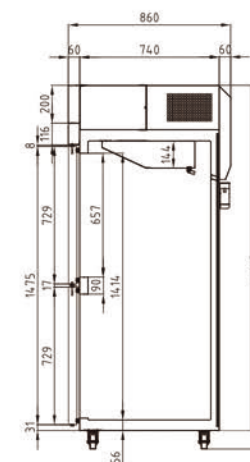

REACH-INS DUAL TEMP

K-Series

NATURAL Refrigerant **N=(HC)**



KRF25-2 (Dual)	
Dimensions	640x860x1926
Capacity	242/222
Energy consumption	3.99Kw/24Hr



KRF45-2H (Dual)	
Dimensions	1260x860x1926
Capacity	576/576
Energy consumption	5.26Kw/24Hr



KRF65-3 (Dual)	
Dimensions	1900x860x1926
Capacity	575/1235
Energy consumption	7.17Kw/24Hr

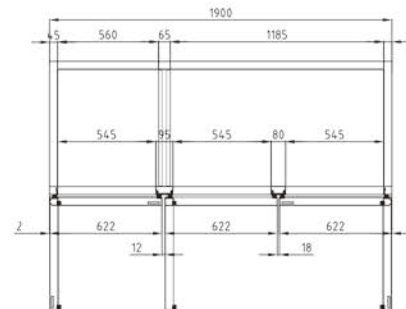
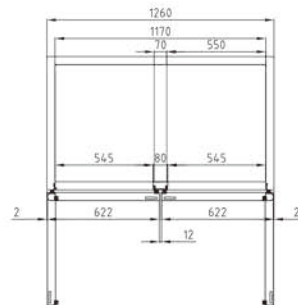
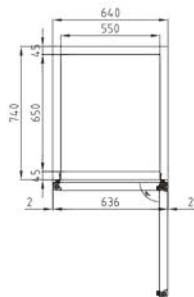

SIDE VIEW

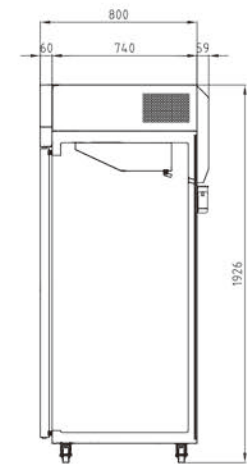

R: 1°C~8°C F: -21°C~-12°C FAN COOLING WxDxH (mm)

NATURAL
Refrigerant

N=(HC)



KRF45-4H (Dual)	
Dimensions	1260x860x1926
Capacity	576/576
Energy consumption	5.26Kw/24Hr



KRF65-6 (Dual)	
Dimensions	1900x860x1926
Capacity	575/1235
Energy consumption	7.17Kw/24Hr

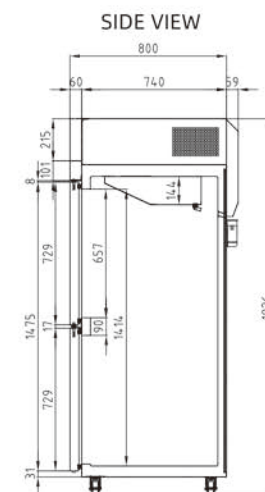
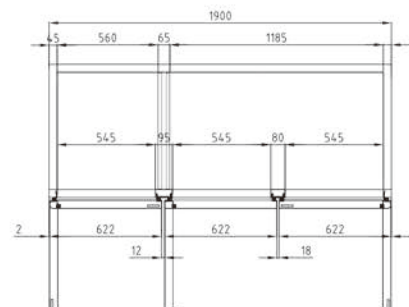
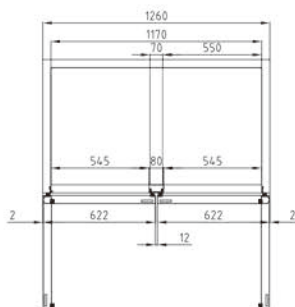

REACH-INS GLASS DOOR

K-Series

NATURAL Refrigerant **N=(HC)**



KR25-1G-N (Fridge)

Dimensions	640x860x1926
Capacity	574
Energy consumption	2.59Kw/24Hr

KF25-1G-N (Freezer)

Dimensions	640x860x1926
Capacity	574
Energy consumption	7.05Kw/24Hr

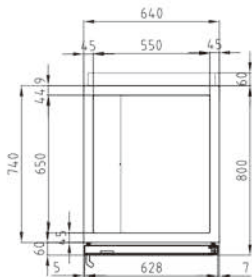

KR45-2G-N (Fridge)

Dimensions	1260x860x1926
Capacity	1215
Energy consumption	4.21Kw/24Hr

KF45-2G-N (Freezer)

Dimensions	1260x860x1926
Capacity	1215
Energy consumption	11.37Kw/24Hr

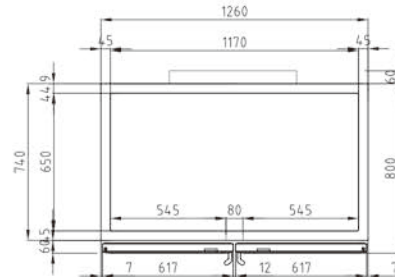

KR65-3G-N (Fridge)

Dimensions	1900x860x1926
Capacity	1876
Energy consumption	6.2Kw/24Hr

Freezer Not Available

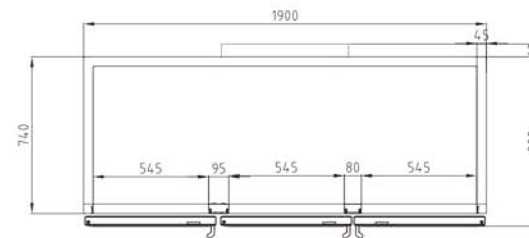

SIDE VIEW

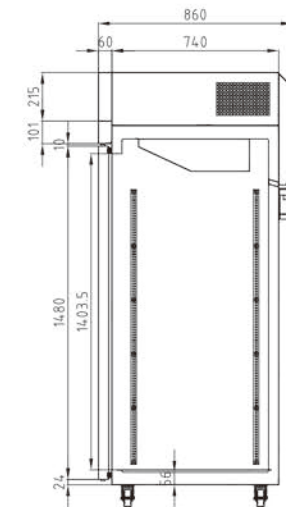

R: 1°C~8°C F: -21°C~-12°C FAN COOLING WxDxH (mm)

NATURAL Refrigerant N=(HC)



KR25-2G-N (Fridge)	
Dimensions	640x860x1926
Capacity	572
Energy consumption	2.64Kw/24Hr



KR45-4G-N (Fridge)	
Dimensions	1260x860x1926
Capacity	1210
Energy consumption	4.25Kw/24Hr



KR65-6G-N (Fridge)	
Dimensions	1900x860x1926
Capacity	1868
Energy consumption	6.2Kw/24Hr

KF25-2G-N (Freezer)	
Dimensions	640x860x1926
Capacity	572
Energy consumption	7.05Kw/24Hr

KF45-4G-N (Freezer)	
Dimensions	1260x860x1926
Capacity	1210
Energy consumption	11.26Kw/24Hr

Low Stock, Please Enquire

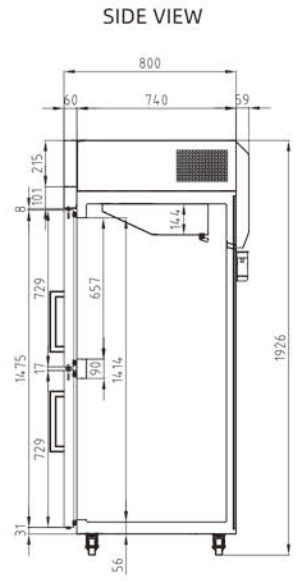
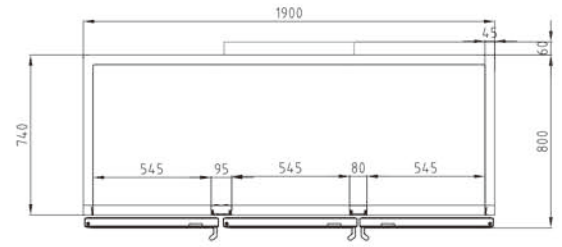
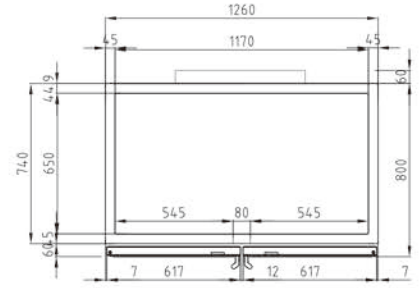
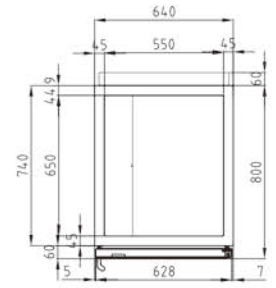

Undercounters & Drawers

Food Prep Tables

Counter Top & Show Cases

Baking-Related Products

Gelato & Icecream Show Cases

Undercounters Refrigerators & Freezers

- ▶ Solid Door
- ▶ Glass Door
- ▶ Dual Temp
- ▶ Drawers

K Series

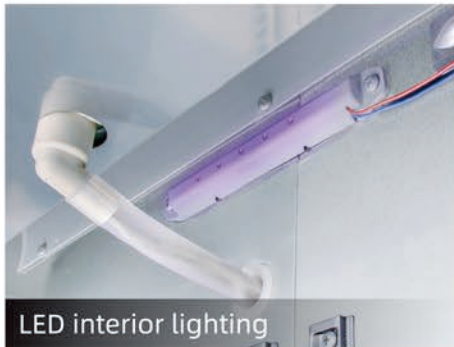

LED interior lighting



Easy grip recessed door handle



All copper refrigeration system



Digital temperature control & monitor

- ✓ Side Mount Compressor Unit
- ✓ Fan Control Cooling System
- ✓ Digital Temperature Control & Monitor
- ✓ LED Interior Lighting
- ✓ Easy Grip Recessd Door Handle
- ✓ Drain Water Evaporation System
- ✓ Highly Efficient Refrigeration System
- ✓ Magnetic Door Gasket
- ✓ CFC Free Insulation
- ✓ Front breathing feature makes it possible to be highly efficient in narrow spaces



PE coated, heavy duty (50kg)



Durable stainless steel drawers



Condenser easy cleaning

UNDERCOUNTER REFRIGERATORS/FREEZERS

K-Series

NATURAL Refrigerant **N=(HC)**



KUR9-1-N (Fridge)

Dimensions	900x700(600)x860
Capacity	198(149)
Energy consumption	1.14Kw/24Hr

KUF9-1-N (Freezer)

Dimensions	900x700(600)x860
Capacity	198(149)
Energy consumption	2.69Kw/24Hr

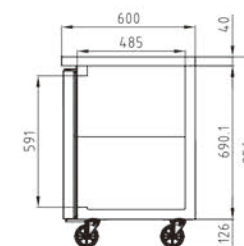

SIDE VIEW (Depth 600mm)



KUR12-2-N (Fridge)

Dimensions	1200x700(600)x860
Capacity	311(234)
Energy consumption	1.39Kw/24Hr

KUF12-2-N (Freezer)

Dimensions	1200x700(600)x860
Capacity	311(234)
Energy consumption	3.75Kw/24Hr

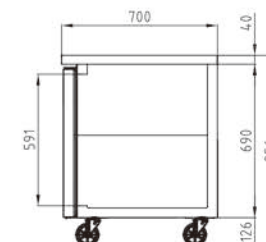
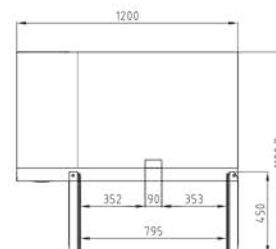

SIDE VIEW (Depth 700mm)



KUR15-2-N (Fridge)

Dimensions	1500x700(600)x860
Capacity	425(319)
Energy consumption	1.67Kw/24Hr

KUF15-2-N (Freezer)

Dimensions	1500x700(600)x860
Capacity	425(319)
Energy consumption	4.54Kw/24Hr

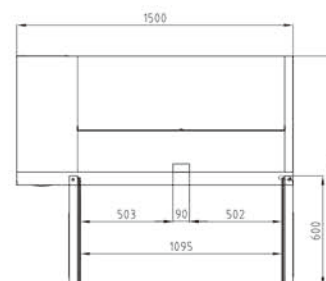

UNDERCOUNTER REFRIGERATORS/FREEZERS

R: 1°C~8°C

F: -21°C~-12°C

FAN COOLING

WxDxH (mm)

NATURAL Refrigerant

N=(HC)



KUR18-3-N (Fridge)

Dimensions	1800x700(600)x860
Capacity	538(400)
Energy consumption	1.91Kw/24Hr

KUF18-3-N (Freezer)

Dimensions	1800x700(600)x860
Capacity	538(400)
Energy consumption	5.55Kw/24Hr

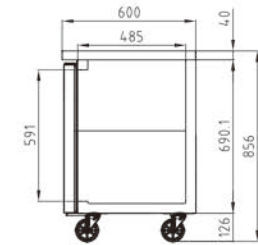
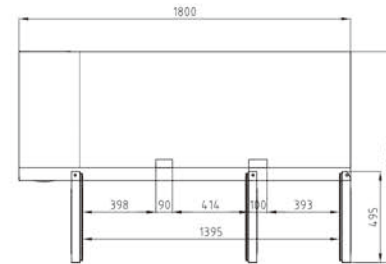

SIDE VIEW (Depth 600mm)



KUR24-4-N (Fridge)

Dimensions	2400x700x860
Capacity	705
Energy consumption	3.1Kw/24Hr

No 600mm Depth Unit Available.

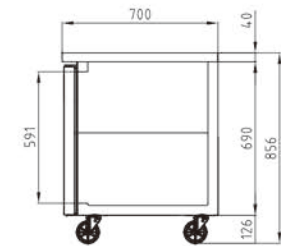
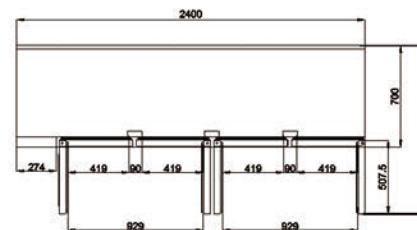

SIDE VIEW (Depth 700mm)

UNDERCOUNTER GLASS DOOR

K-Series

NATURAL Refrigerant **N=(HC)**



KGR9-1-N (Fridge)	
Dimensions	900x700(600)x860
Capacity	198(149)
Energy consumption	1.92Kw/24Hr

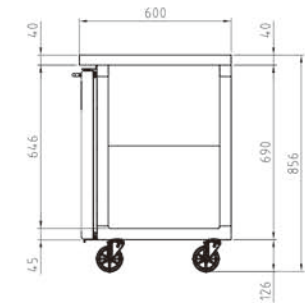

SIDE VIEW (Depth 600mm)



KGR12-2-N (Fridge)	
Dimensions	1200x700(600)x860
Capacity	311(234)
Energy consumption	2.22Kw/24Hr

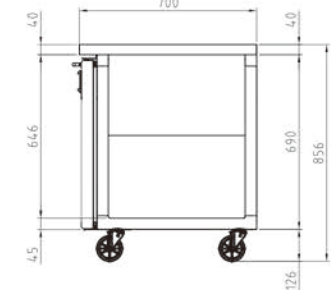
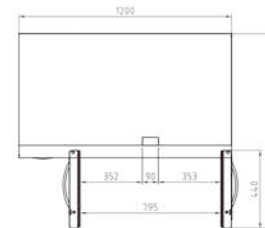

SIDE VIEW (Depth 700mm)



KGR15-2-N (Fridge)	
Dimensions	1500x700(600)x860
Capacity	425(319)
Energy consumption	2.67Kw/24Hr

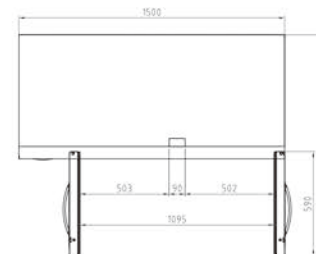

UNDERCOUNTER GLASS DOOR

R: 1°C~8°C
F: -21°C~-12°C
FAN COOLING
WxDxH (mm)

NATURAL Refrigerant
N=(HC)

Reach-In Refrigerators & Freezers

Undercounters & Drawers

Food Prep Tables

Counter Top & Show Cases

Baking-Related Products

Gelato & Icecream Show Cases



KGR18-3-N (Fridge)	
Dimensions	1800x700(600)x860
Capacity	538(400)
Energy consumption	3.15kw/24Hr

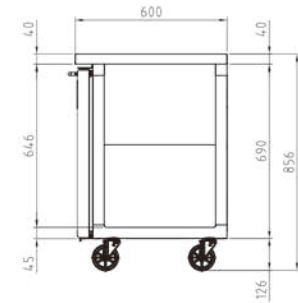
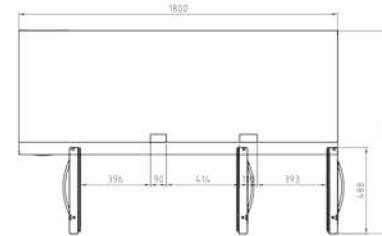

SIDE VIEW (Depth 600mm)



KGR24-4-N (Fridge)	
Dimensions	2400x700x860
Capacity	705
Energy consumption	5.1Kw/24Hr

No 600mm Depth Unit Available

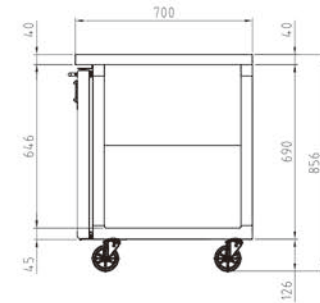
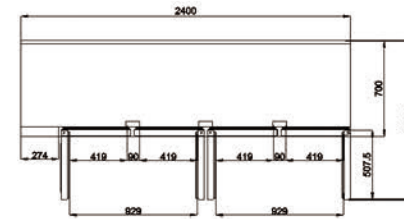

SIDE VIEW (Depth 700mm)

REFRIGERATOR MANUFACTURER
Turbo air

UNDERCOUNTER DUAL TEMP

K-Series

R: 1°C~8°C

F: -21°C~-12°C

FAN COOLING

WxDxH (mm)

NATURAL Refrigerant

N=(HC)



KURF12-2-N (Dual)

Dimensions	1200x700x860
Capacity	121/136
Energy consumption	3.22Kw/24Hr

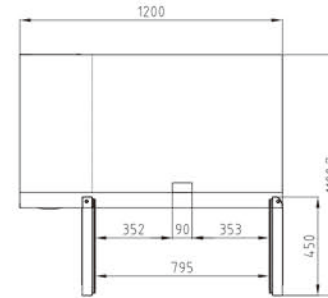

KURF15-2-N (Dual)

Dimensions	1500x700x860
Capacity	171*191
Energy consumption	3.88Kw/24Hr

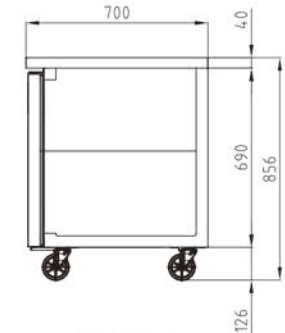
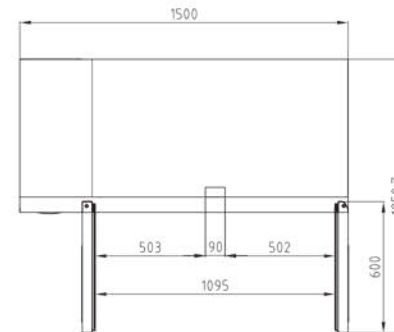

SIDE VIEW



KURF18-3-N (Dual)

Dimensions	1800x700x860
Capacity	151/287
Energy consumption	4.35Kw/24Hr

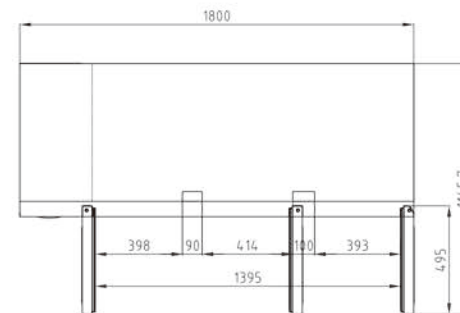

UNDERCOUNTER DRAWERS

R: 1°C~8°C

F: -21°C~-12°C

FAN COOLING

WxDxH (mm)

NATURAL Refrigerant

N=(HC)



KUR9-2D-2-N (Fridge)

Dimensions	900x700x860
Capacity	198
Energy consumption	1.35Kw/24Hr

KUF9-2D-2-N (Freezer)

Dimensions	900x700x860
Capacity	198
Energy consumption	2.75Kw/24Hr

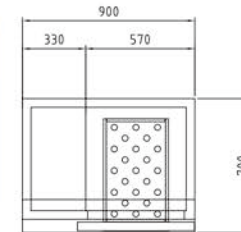

KUR12-2D-2-N (Fridge)

Dimensions	1200x700x860
Capacity	311
Energy consumption	1.47Kw/24Hr

KUF12-2D-2-N (Freezer)

Dimensions	1200x700x860
Capacity	311
Energy consumption	3.75Kw/24Hr

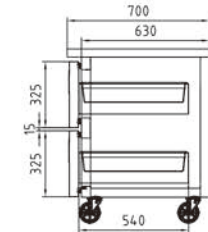
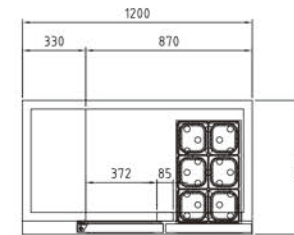

SIDE VIEW



KUR12-2D-4-N (Fridge)

Dimensions	1200x700x860
Capacity	311
Energy consumption	1.47Kw/24Hr

KUF12-2D-4-N (Freezer)

Dimensions	1200x700x860
Capacity	311
Energy consumption	3.75Kw/24Hr

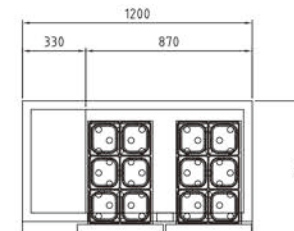

LED Light on Solid Doors Only

UNDERCOUNTER DRAWERS

K-Series

NATURAL Refrigerant **N=(HC)**



KUR18-2D-2-N (Fridge)

Dimensions	1800x700x860
Capacity	538
Energy consumption	1.89Kw/24Hr

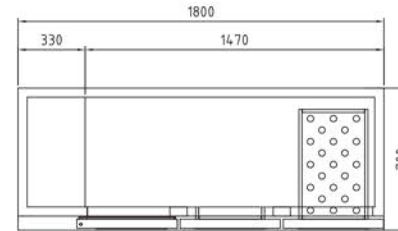

KUR18-2D-4-N (Fridge)

Dimensions	1800x700x860
Capacity	538
Energy consumption	1.89Kw/24Hr

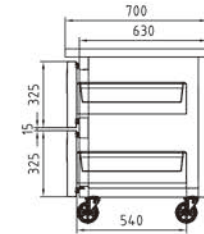
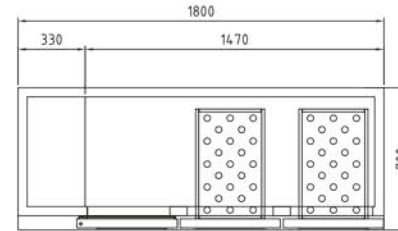

SIDE VIEW



KUR18-2D-6-N (Fridge)

Dimensions	1800x700x860
Capacity	538
Energy consumption	1.89Kw/24Hr

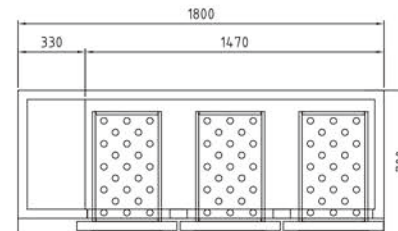

LED Light on Solid Doors Only

UNDERCOUNTER DRAWERS

R: 1°C~8°C

F: -21°C~-12°C

FAN COOLING

WxDxH (mm)

NATURAL Refrigerant

N=(HC)



KUR9-3D-3-N (Fridge)

Dimensions	900x700x860
Capacity	198
Energy consumption	1.35Kw/24Hr

KUF9-3D-3-N (Freezer)

Dimensions	900x700x860
Capacity	198
Energy consumption	2.75Kw/24Hr

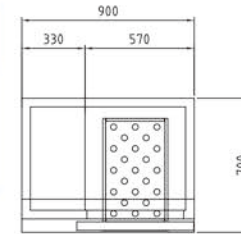

KUR12-3D-3-N (Fridge)

Dimensions	1200x700x860
Capacity	311
Energy consumption	1.47Kw/24Hr

KUF12-3D-3-N (Freezer)

Dimensions	1200x700x860
Capacity	311
Energy consumption	3.75Kw/24Hr

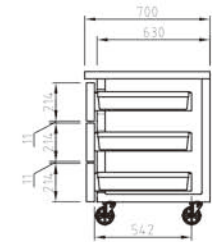
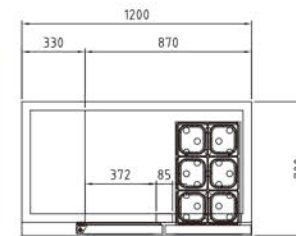

SIDE VIEW



KUR12-3D-6-N (Fridge)

Dimensions	1200x700x860
Capacity	311
Energy consumption	1.47Kw/24Hr

KUF12-3D-6-N (Freezer)

Dimensions	1200x700x860
Capacity	311
Energy consumption	3.75Kw/24Hr

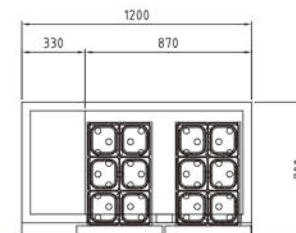

LED Light on Solid Doors Only

UNDERCOUNTER DRAWERS

K-Series

R: 1°C~8°C

F: -21°C~-12°C

FAN COOLING

WxDxH (mm)

NATURAL Refrigerant

N=(HC)



KUR18-3D-3-N (Fridge)

Dimensions	1800x700x860
Capacity	538
Energy consumption	1.89Kw/24Hr

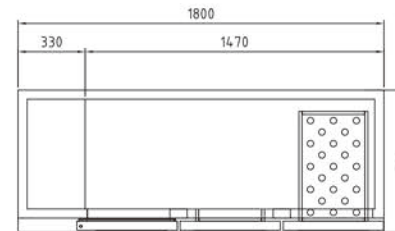

KUR18-3D-6-N (Fridge)

Dimensions	1800x700x860
Capacity	538
Energy consumption	1.89Kw/24Hr

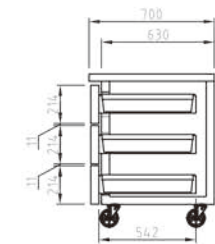
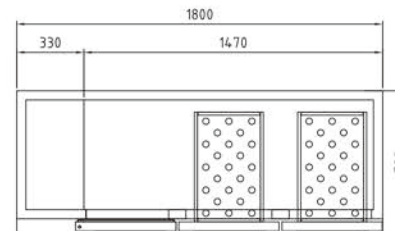

SIDE VIEW



KUR18-3D-9-N (Fridge)

Dimensions	1800x700x860
Capacity	538
Energy consumption	1.89Kw/24Hr

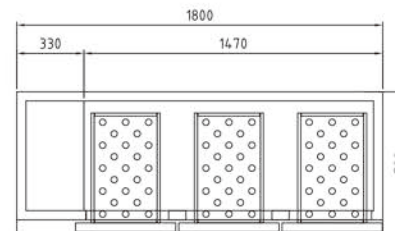

LED Light on Solid Doors Only

Food Prep Tables



SALAD PREP TABLES (BUFFET)

K-Series

NATURAL Refrigerant **N=(HC)**



KSR9-1-N (Fridge)	
Dimensions	900x700x860
Capacity	213
Energy consumption	5.12Kw/24Hr

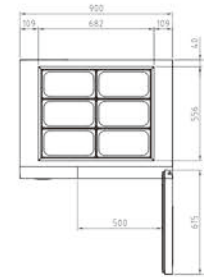

KSR12-2-N (Fridge)	
Dimensions	1200x700x860
Capacity	309
Energy consumption	5.75Kw/24Hr

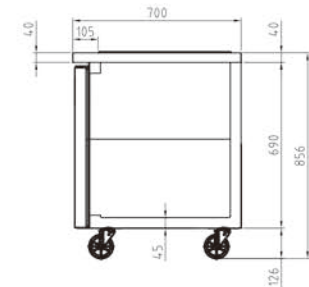
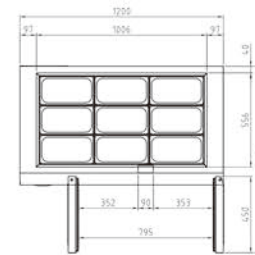

SIDE VIEW



KSR15-2-N (Fridge)	
Dimensions	1500x700x860
Capacity	420
Energy consumption	6.21Kw/24Hr

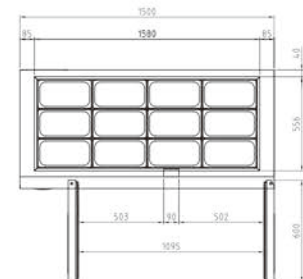

GN pans not included

SALAD PREP TABLES (BUFFET)

R: 1°C~8°C

FAN COOLING

WxDxH (mm)



KSR18-3-N (Fridge)

Dimensions	1800x700x860
Capacity	516
Energy consumption	6.92Kw/24Hr

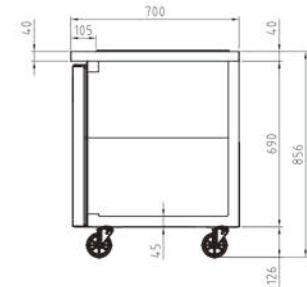
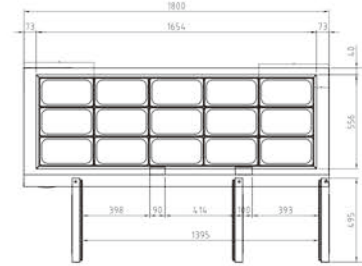

SIDE VIEW



KSR24-4

Dimensions	2400x700x860
Capacity	690
Power	390W

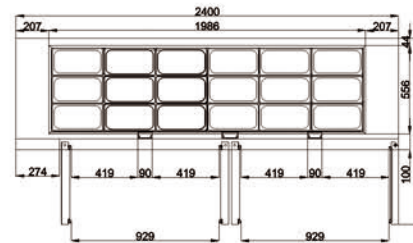

GN pans not included

REFRIGERATOR MANUFACTURER
Turbo air

SALAD PREP TABLES (HOOD LID)

K-Series

R: 1°C~8°C

FAN COOLING

WxDxH (mm)

NATURAL Refrigerant

N=(HC)



KHR9-1-N (Fridge)

Dimensions	900x700x978
Capacity	213
Energy consumption	4.83Kw/24Hr

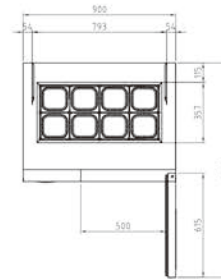

KHR12-2-N (Fridge)

Dimensions	1200x700x978
Capacity	309
Energy consumption	5.21Kw/24Hr

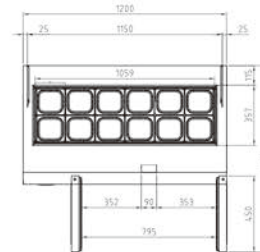

KHR15-2-N (Fridge)

Dimensions	1500x700x978
Capacity	420
Energy consumption	5.57Kw/24Hr

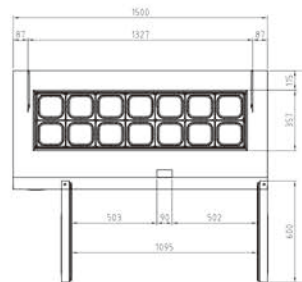

KHR18-3-N (Fridge)

Dimensions	1800x700x978
Capacity	516
Energy consumption	6.25Kw/24Hr

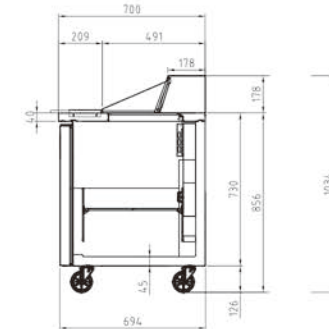
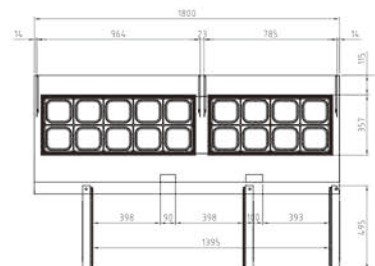

SIDE VIEW

1/6 GN Pans Included
Chopping Board Included

PIZZA TABLES

R: 1°C~8°C
 FAN COOLING
 WxDxH (mm)



CTPR-44SD (Fridge)

Dimensions	1117x820x1069
Capacity	396
Energy consumption	4Kw/24Hr

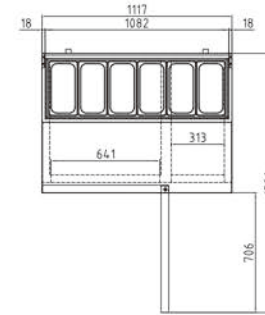

CTPR-67SD (Fridge)

Dimensions	1702x820x1069
Capacity	566
Energy consumption	4.5Kw/24Hr

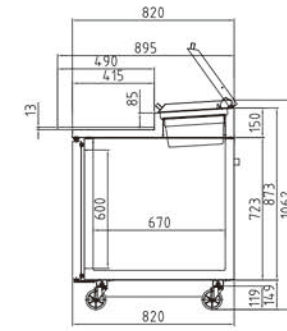
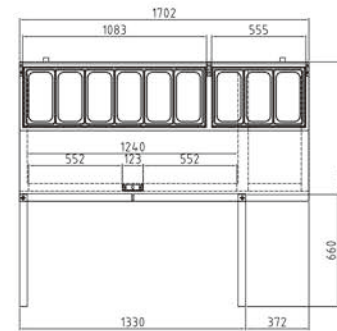

SIDE VIEW



CTPR-93SD (Fridge)

Dimensions	2360x820x1069
Capacity	878
Energy consumption	5.5Kw/24Hr

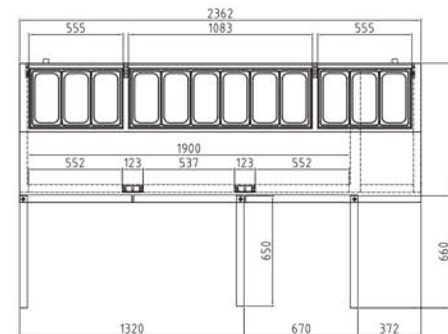

1/3 GN Pans Included
 Chopping Board Included

CHEF BASE REFRIGERATORS

R: 1°C~8°C

FAN COOLING

WxDxH (mm)

NATURAL Refrigerant

N=(HC)



TCB12-2-N (Fridge)

Dimensions	1200x700x585
Capacity	62
Energy consumption	3.27Kw/24Hr

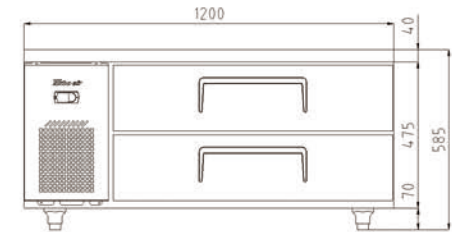
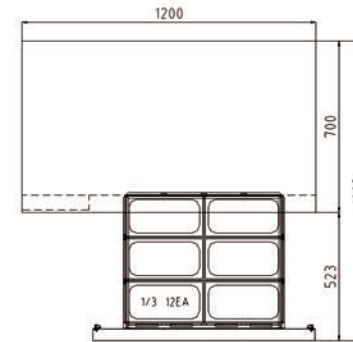

TCB12-4-N (Fridge)

Dimensions	1200x700x585
Capacity	62
Energy consumption	3.27Kw/24Hr

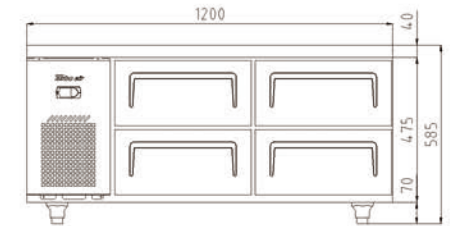
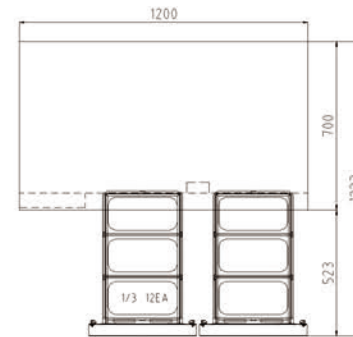

TCB15-4-N (Fridge)

Dimensions	1500x700x585
Capacity	93
Energy consumption	3.09Kw/24Hr

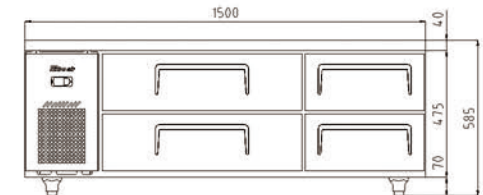
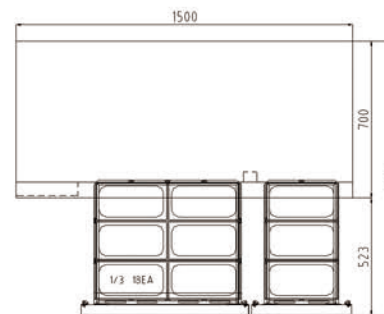

CHEF BASE REFRIGERATORS

R: 1°C~8°C

FAN COOLING

WxDxH (mm)

NATURAL Refrigerant

N=(HC)



TCB18-4-N (Fridge)

Dimensions	1800x700x585
Capacity	124
Energy consumption	2.76Kw/24Hr

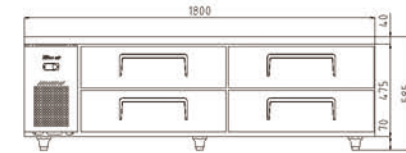
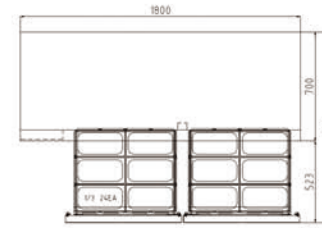

TCB18-6-N (Fridge)

Dimensions	1800x700x585
Capacity	124
Energy consumption	2.76Kw/24Hr

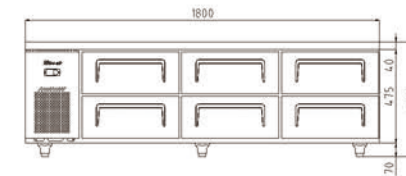
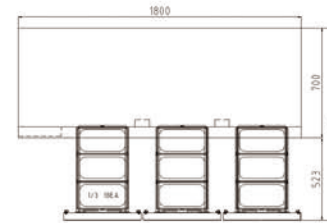

REFRIGERATOR MANUFACTURER
Turbo air

Glass Door Merchandiser



GLASS DOOR MERCHANDISER

R: 1°C~8°C

FAN COOLING

WxDxH (mm)



FRS-600RP (Fridge)

Dimensions	731x764x2105
Capacity	602
Energy consumption	330w

FRS-1350RS (Fridge)

Dimensions	1420x837x2076
Capacity	1315
Energy consumption	960w

FRS-650F (Freezer)

Dimensions	685x756x2064
Capacity	651
Energy consumption	1020w

FRS-1250F (Freezer)

Dimensions	1382x756x2064
Capacity	1220
Energy consumption	1400w

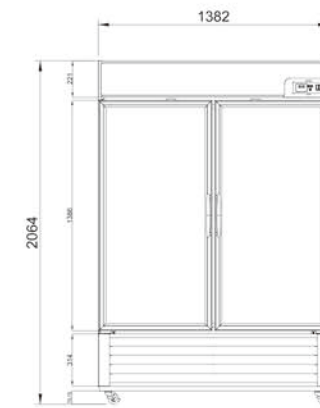
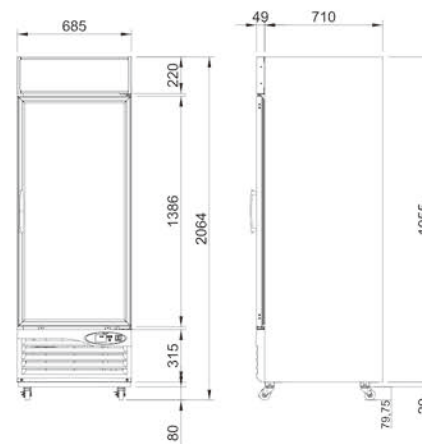
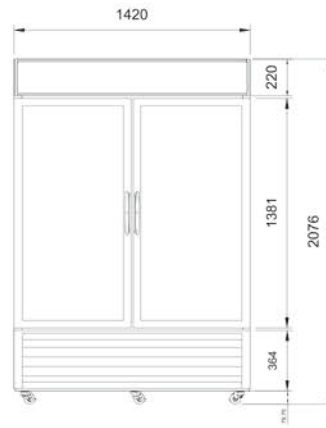

BACK BAR

NATURAL Refrigerant **N=(HC)**



TB6-8H-N (Fridge)

Dimensions	600x550x800(900)
Capacity	100(116)
Energy consumption	229w

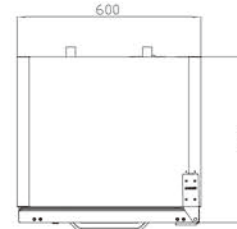

TB9-8H-N (Fridge)

Dimensions	900x550x800(900)
Capacity	157(182)
Energy consumption	255w

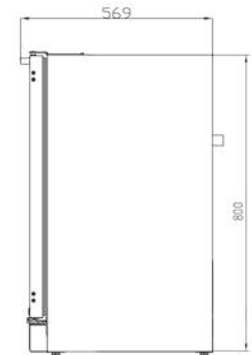
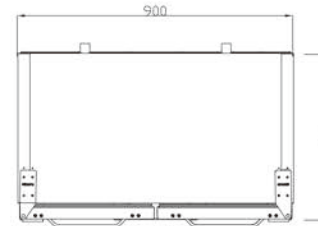

SIDE VIEW



TB13-8H-N (Fridge)

Dimensions	1352x550x800(900)
Capacity	246(285)
Energy consumption	288w

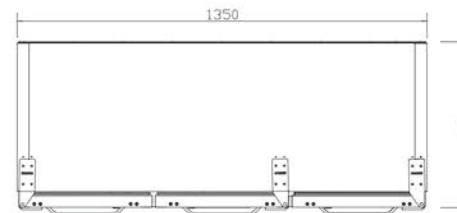

No Legs / Castors

BACK BAR

R: 1°C~8°C

FAN COOLING

WxDxH (mm)



TBB-2SGD (Fridge)

Dimensions	1494x692x1066
Capacity	580
Energy consumption	288w

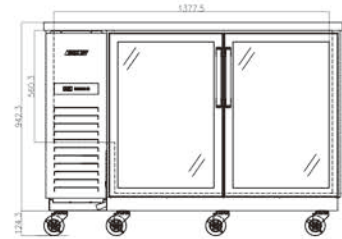

TBB-3SGD (Fridge)

Dimensions	1754x692x1066
Capacity	723
Energy consumption	368w

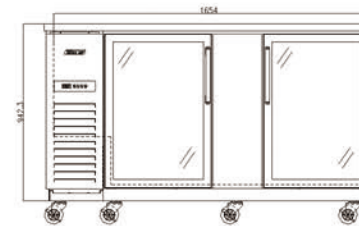

TBB-3SGD
FRONT VIEW

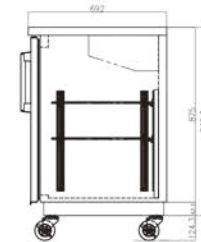

TBB-4SGD (Fridge)

Dimensions	2296x692x1066
Capacity	866
Energy consumption	461w

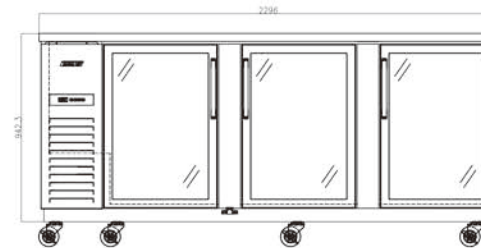

Rectangle Bakery Cases





Tempered Electrical-heating Glass

Electrically-heated Ultra Clear Glass is tempered for safety. High transparency maximizes display effect. Heating Glass prevents a condensation on glasses of the Display.

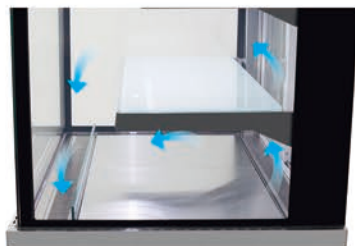

Air Flow

Front air intake and rear exhaust, balanced air flow provides uniformly maintained temperature within the food zone.



Drain Case With Warning System

The warning system alarms automatically when the drain case is full, preventing the overflow of the drain water.

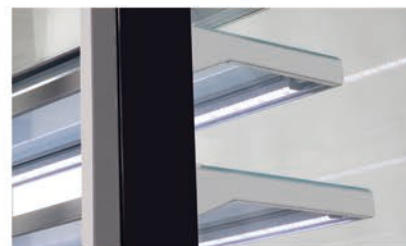

LED Lamp

The Eco Friendly LED Lamp with High brightness makes product presentation at its best and most beautiful.



Digital Temperature Control

Using the Imported Display panel and PCB, the adjustment of temperature, power supply, and lamp is more precise and convenient.



Air Heating System

Side fan motor provides proper warm air to prevent a condensation under unfavorable operating conditions.



Temperature Display

Real-time temperature display in the cabinet. Adjustable temperature control.

Customizable Options



SUS & Colored Steel



SUS(Original)

Black

White



Marble



Brown-Stripes

Yellow-Stripes

Black-Stripes

Bluish yellow-Stripes

Black White-Stripes

White-Stripes



Door Type



Front sliding glass doors

Back sliding glass doors



Lighting System

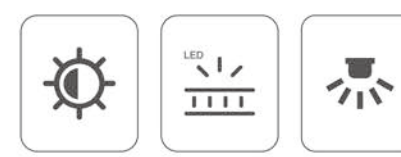

Light colour

Light guide plate

LED lamp

RECTANGLE BAKERY CASES

R: 3°C~8°C FAN COOLING WxDxH (mm)



The model shown in the picture is TBP1800-1

Bespoke Units: Need 12 Weeks Lead Time

	TBP900-1	TBP1200-1	TBP1500-1	TBP1800-1
Dimensions	900x700x1175	1200x700x1175	1500x700x1175	1800x700x1175
Capacity	255	345	440	530
Energy consumption	620w	670w	830w	850w

Customizable Options

- SUS & Colored Steel
- Marble
- Door Type
- Light colour
- Light guide plate
- LED lamp

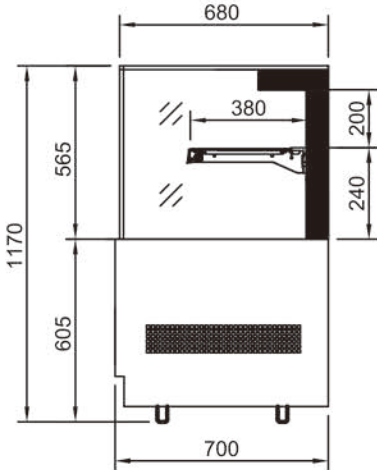
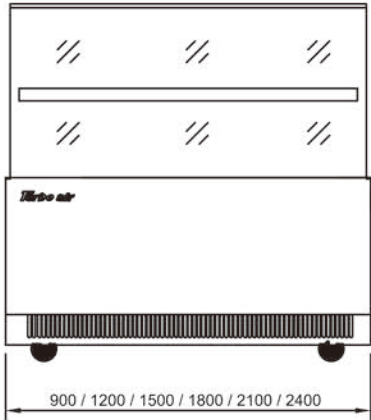

Note: The model with width of less than or equal to 1800mm has 2 doors in the back. The model with width of more than 1800mm has 4 doors in the back.

RECTANGLE BAKERY CASES

R: 3°C~8°C FAN COOLING WxDxH (mm)



The model shown in the picture is TBP2100-2

	TBP900-2	TBP1200-2	TBP1500-2	TBP1800-2
Dimensions	900x700x1375	1200x700x1375	1500x700x1375	1800x700x1375
Capacity	355	485	615	740
Energy consumption	670w	830w	850w	880w

Customizable Options

- SUS & Colored Steel
- Marble
- Door Type
- Light colour
- Light guide plate
- LED lamp

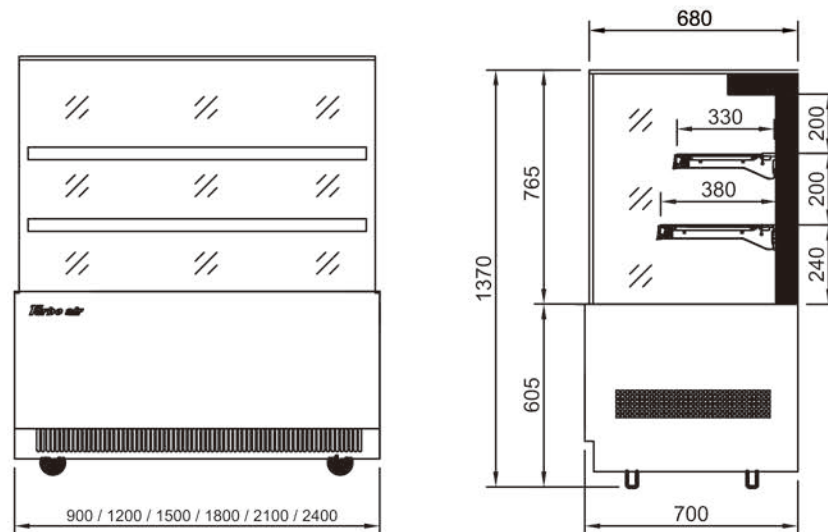

Note: The model with width of less than or equal to 1800mm has 2 doors in the back. The model with width of more than 1800mm has 4 doors in the back.

RECTANGLE BAKERY CASES

R: 3°C~8°C

FAN COOLING

WxDxH (mm)



The model shown in the picture is TBP1500-3

	TBP900-3	TBP1200-3	TBP1500-3	TBP1800-3
Dimensions	900x700x1575	1200x700x1575	1500x700x1575	1800x700x1575
Capacity	455	620	785	950
Energy consumption	830w	860w	880w	920w

Customizable Options

- SUS & Colored Steel
- Marble
- Door Type
- Light colour
- Light guide plate
- LED lamp

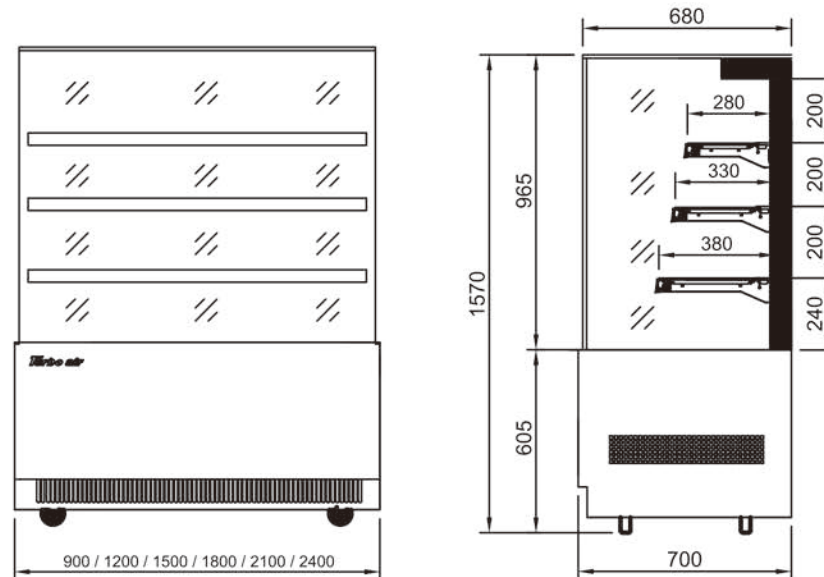

Note: The model with width of less than or equal to 1800mm has 2 doors in the back.
The model with width of more than 1800mm has 4 doors in the back.

Bespoke Unit

Lead Time: 12 Weeks



SUSHI CASES



	CTST-1200	CTST-1500	CTST-1800
Dimensions	1200x335x225	1500x335x225	1800x335x225
Capacity	1/4 GN Pans x 5	1/4 GN Pans x 7	1/4 GN Pans x 9
Energy consumption	150w	150w	150w

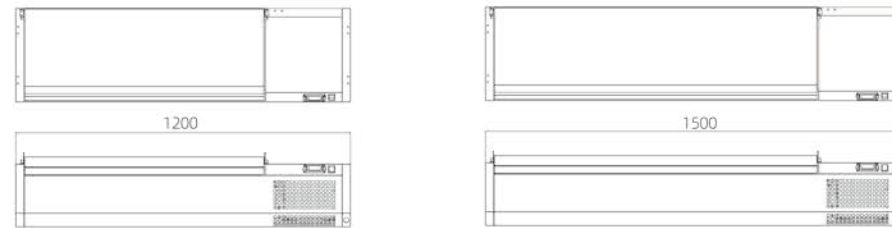

	CTST-1200G	CTST-1500G	CTST-1800G
Dimensions	1200x335x225	1500x335x425	1800x335x425
Capacity	1/4 GN Pans x 5	1/4 GN Pans x 7	1/4 GN Pans x 9
Energy consumption	150w	150w	150w

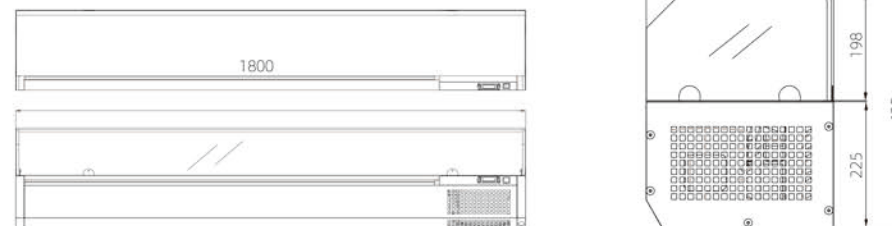

ROUND BAKERY CASES

R: 3°C~8°C FAN COOLING WxDxH (mm)



The model shown in the picture is TBR1200-2

	TBR900-2	TBR1200-2	TBR1500-2	TBR1800-2
Dimensions	900x700x1370	1200x700x1370	1500x700x1370	1800x700x1370
Capacity	355	485	615	740
Energy consumption	670w	830w	850w	880w

Customizable Options

- SUS & Colored Steel
- Marble
- Light colour
- Light guide plate
- LED lamp

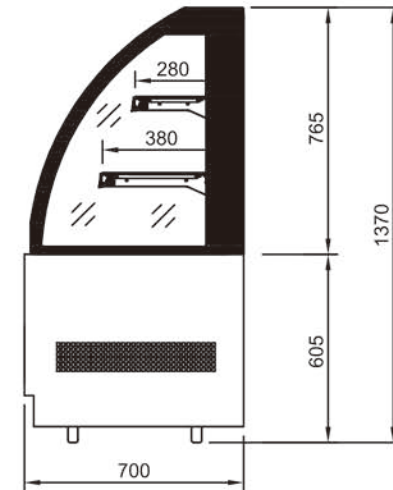

BAKERY CASES HIGH

R: 3°C~8°C

FAN COOLING

WxDxH (mm)



The model shown in the picture is TBH-1200

	TBH-900	TBH-1200	TBH-1500	TBH-1800
Dimensions	900x700x1910	1200x700x1910	1500x700x1910	1800x700x1910
Capacity	340	470	600	725
Energy consumption	800w	880w	950w	1000w

Customizable Options

- SUS & Colored Steel
- Light colour
- Light guide plate
- LED lamp

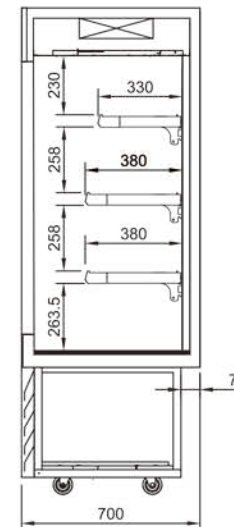

Sandwich Cases





High-quality Tempered Glass

Electrically-heated Ultra Clear Glass is tempered for safety. High transparency maximizes display effect. Heating Glass prevents a condensation on glasses of the Display.



Quiet-Design

Quiet-design provides you a better experience.



Customized Dimension

The equipment's width can be customized within 700mm~1200mm.



Drain Case With Warning System

The warning system alarms automatically when the drain case is full, preventing the overflow of the drain water.



High Efficient Radiating System

Powerful and Effective Radiating System ensures that equipment operates properly.



Various Types of Exterior Design

We can provide a variety of design types to meet our customer's various needs.

Customizable Options



SUS & Colored Steel

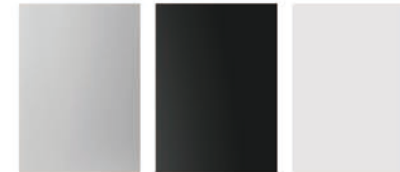

SUS (Original)

Black

White



Marble



Brown-Stripes

Yellow-Stripes

Black-Stripes

Bluish yellow-Stripes

Black White-Stripes

White-Stripes

BESPOKE UNIT

R: 5°C~10°C

FAN COOLING

WxDxH (mm)

SANDWICH CASES



The model shown in the picture is TOS-1500

	TOS-900	TOS-1200	TOS-1500	TOS-1800
Dimensions	900x900x840(920)	1200x900x840(920)	1500x900x840(920)	1800x900x840(920)
Capacity	100(145)	135(200)	170(255)	205(310)
Energy consumption	400w	500w	600w	705w

Customizable Options



SUS & Colored Steel



Marble

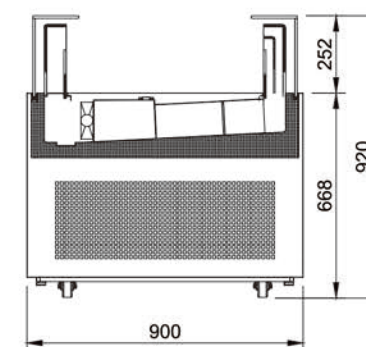
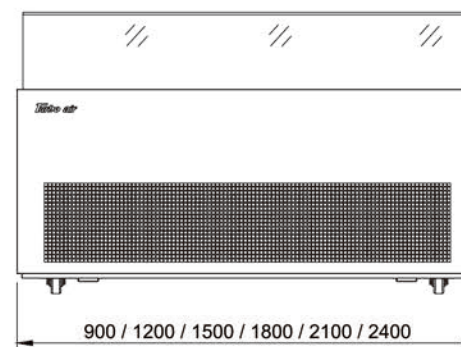
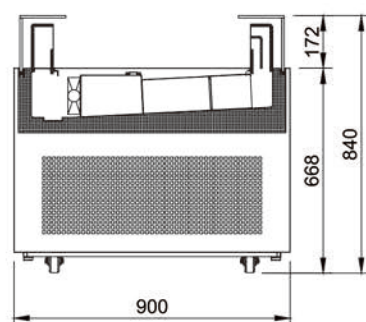
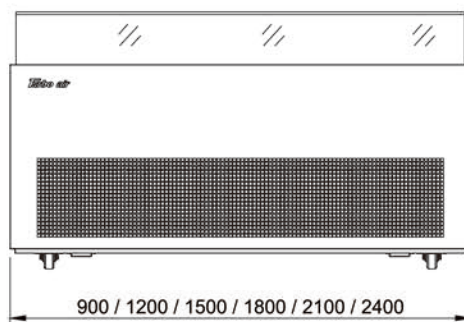

SANDWICH CASES

R: 5°C~10°C

FAN COOLING

WxDxH (mm)



The model shown in the picture is TOS-1500A

	TOS-900A	TOS-1200A	TOS-1500A	TOS-1800A
Dimensions	900x900x920	1200x900x920	1500x900x920	1800x900x920
Capacity	123	168	212	257
Energy consumption	400w	500w	600w	705w

Product features:



sliding glass door:
Prevent the loss of cold air effectively
Enhance energy saving effect.

Customizable Options

- SUS & Colored Steel
- Marble

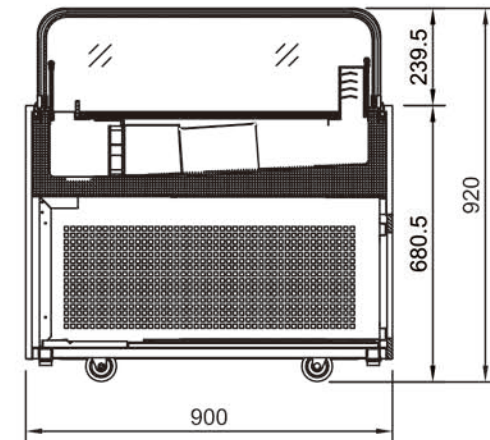
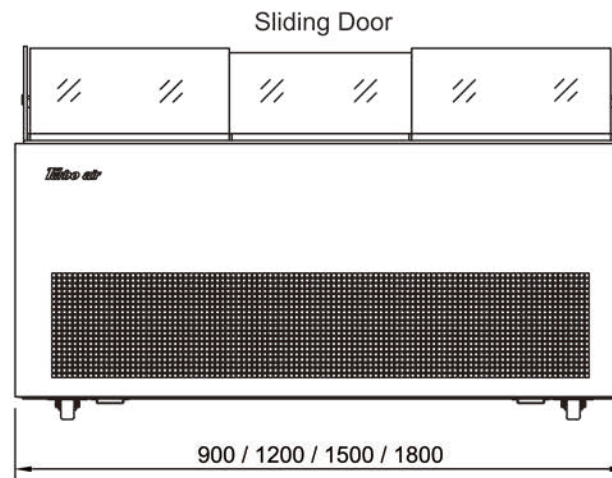

BESPOKE UNIT

R: 5°C~10°C

FAN COOLING

WxDxH (mm)

SANDWICH CASES



The model shown in the picture is TOS-1200P

	TOS-900P	TOS-1200P	TOS-1500P	TOS-1800P
Dimensions	900x900x920	1200x900x920	1500x900x920	1800x900x920
Capacity	164	226	289	352
Energy consumption	400w	500w	600w	705w

Product features:



Deeper depth: more foods on display.
Vertical air outlet: better cooling effect.



Design of lower indent makes better radiating effect.
Ensure the normal operation of equipment, prolong the service life.

Customizable Options

SUS & Colored Steel

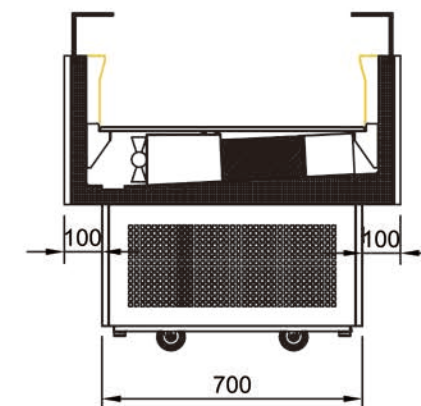
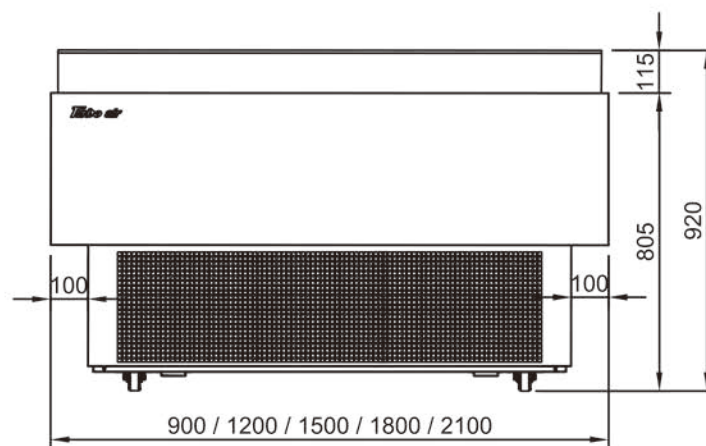

SANDWICH CASES

R: 5°C~10°C

FAN COOLING

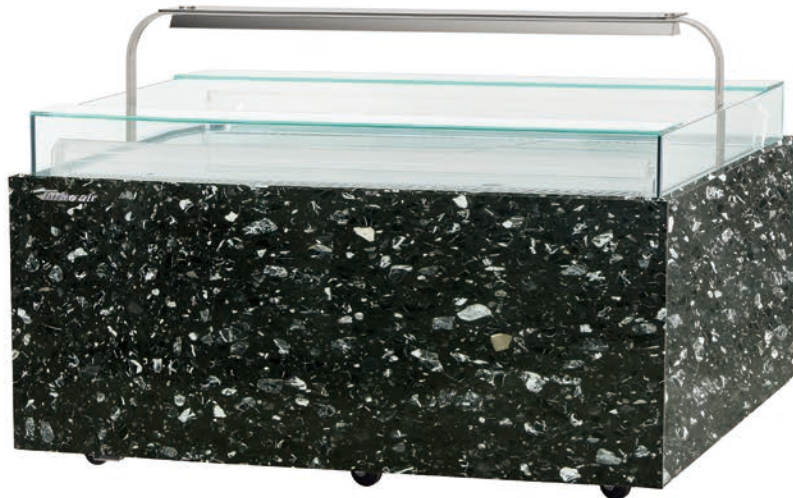

WxDxH (mm)



The model shown in the picture is TOS-1800C

	TOS-900C	TOS-1200C	TOS-1500C	TOS-1800C
Dimensions	900x900x1055	1200x900x1055	1500x900x1055	1800x900x1055
Capacity	110	150	180	200
Energy consumption	400w	500w	600w	705w

Customizable Options

-  SUS & Colored Steel
-  Marble

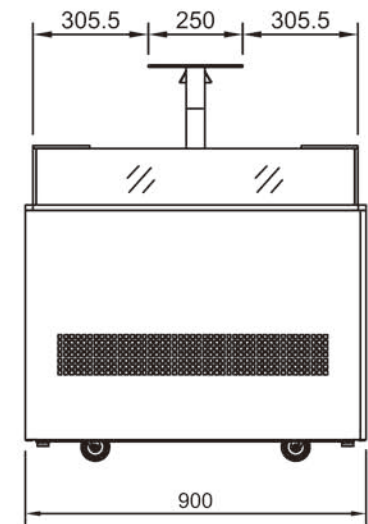
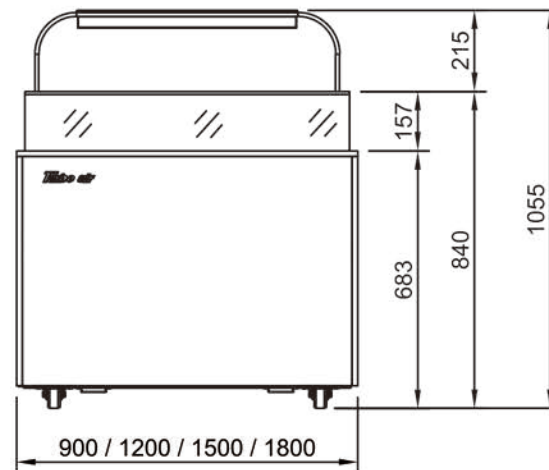

BESPOKE UNIT

R: 5°C~10°C FAN COOLING WxDxH (mm)

SANDWICH CASES



	TOS-900R	TOS-1200R	TOS-1500R	TOS-1800R
Dimensions	900x900x920	1200x900x920	1500x900x920	1800x900x920
Capacity	123	168	212	257
Energy consumption	400w	500w	600w	705w

Product features:



Curved glass design, More varieties are available.

The model shown in the picture is TOS-1500R

Customizable Options

- SUS & Colored Steel
- Marble

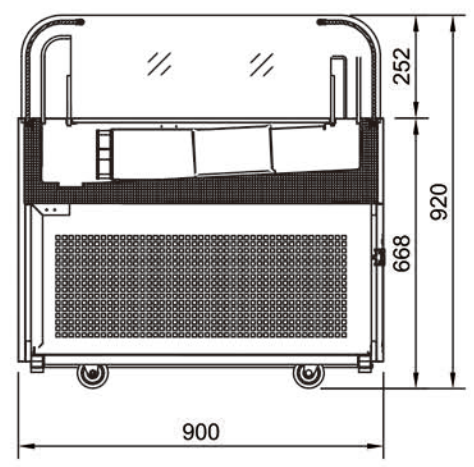
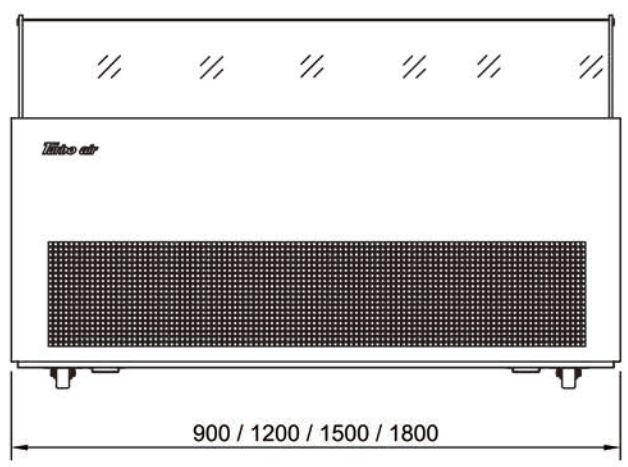

SANDWICH CASES

R: 5°C~10°C

FAN COOLING

WxDxH (mm)



The model shown in the picture is TBS-1800F

	TBS-900F	TBS-1200F	TBS-1500F	TBS-1800F
Dimensions	900x900x1158	1200x900x1158	1500x900x1158	1800x900x1158
Capacity	230	315	395	480
Energy consumption	400w	500w	600w	705w

Product features:



Prevent the loss of cold air effectively, Enhance energy saving effect.
Tempered Ultra Clear Glass. High transparency is up to more than 92%.

Customizable Options

- SUS & Colored Steel
- Marble

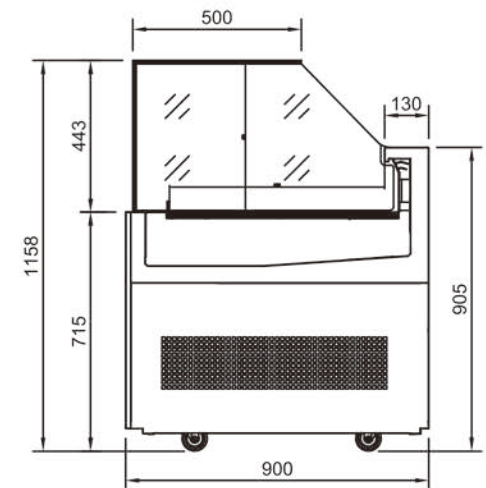
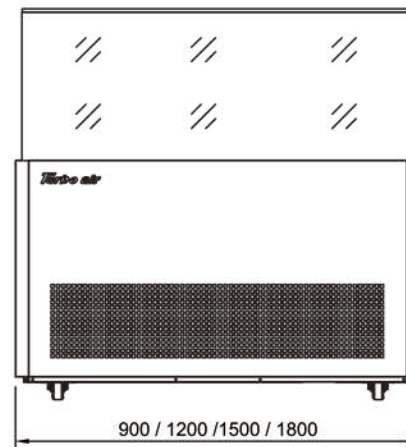

Chocolate Cases





Tempered Electrical-heating Glass

Electrically-heated Ultra Clear Glass is tempered for safety. High transparency maximizes display effect. Heating Glass prevents a condensation on glasses of the Display.



Mini-LED Lamp

Mini-LED Lamp makes display more clear and gorgeous.



LED Base Plate Lamp

Enhance the brightness in the cabinet to optimize display effects.



Rail-mounted Drawers

Open and close smoothly. Convenient access with fast service.



Drain Case With Warning System

The warning system alarms automatically when the drain case is full, preventing the overflow of the drain water.



Digital Temperature Control

Using the Imported Display panel and PCB, the adjustment of temperature, power supply, and lamp is more precise and convenient.



Back Refrigeration Storage Space

Other storage room on the back side, it provides much more space for food storage.

Customizable Options



SUS & Colored Steel



SUS(Original)

Black

White



Marble



Brown-Stripes

Yellow-Stripes

Black-Stripes

Bluish yellow-Stripes

Black White-Stripes

White-Stripes



Lighting System

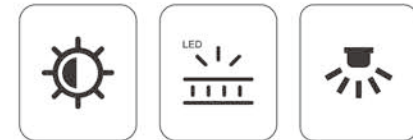

Light colour

Light guide plate

LED lamp

CHOCOLATE CASES

SHOW: 5°C~10°C STORE: 10°C~14°C

FAN COOLING

WxDxH (mm)



The model shown in the picture is TCD-1500

	TCD-900	TCD-1200	TCD-1500	TCD-1800	TCD-2100
Dimensions	900x800x1060	1200x800x1060	1500x800x1060	1800x800x1060	2100x800x1060
Capacity	211	288	345	410	475
Energy consumption	800w	900w	970w	1080w	1150w

Customizable Options

- SUS & Colored Steel
- Marble
- Light colour
- Light guide plate
- LED lamp

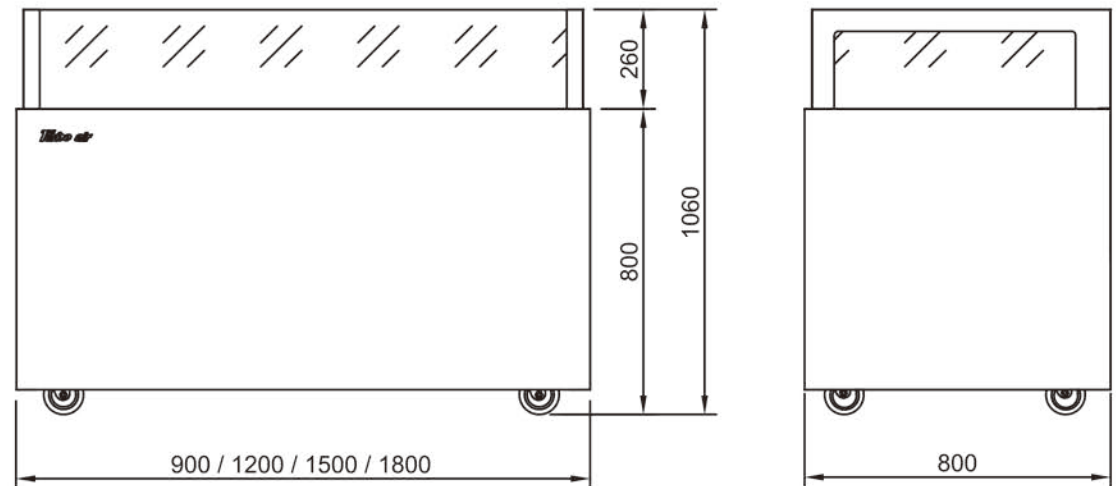



High-quality Tempered Glass

All glass is tempered for safety. The high transparency maximizes display effects.

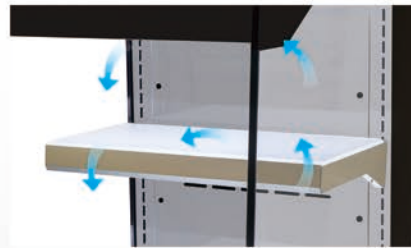

Air Flow

Front air intake and rear exhale, balanced air flow provides uniformly maintained temperature within the food zone.

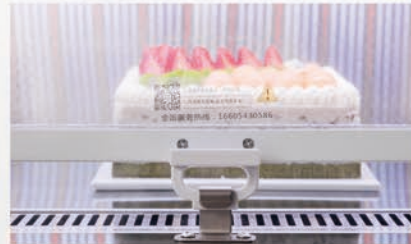

Air Curtain

Prevent the loss of cooling air, Optimize a storage environment.

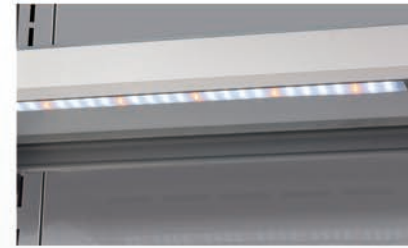

LED Lamp

The Eco Friendly LED Lamp with High brightness makes the display more clear and gorgeous.



Digital Temperature Control

Using the Imported Display panel and PCB, the adjustment of temperature, power supply, and lamp is more precise and convenient.



Honeycomb Patterned Guide Panel

Ensure even distribution of cold air in the cabinet, so as to keep the temperature consistent.

Customizable Options



SUS & Colored Steel



SUS(Original)

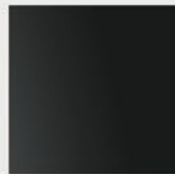

Black

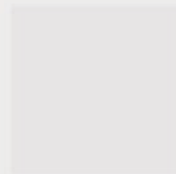

White



Lamp System



Light colour



Light guide plate



LED lamp

Open cases



OPEN CASES SLIM

BESPOKE UNIT

R: 5°C~10°C

FAN COOLING

WxDxH (mm)

NATURAL Refrigerant

N=(HC)



TOM500-4-N (Fridge)

Dimensions	500x650x1910
Capacity	140
Energy consumption	650w

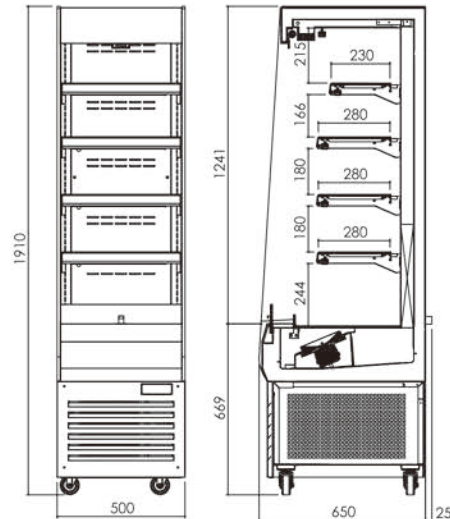

TOM500-2-N (Fridge)

Dimensions	500x650x1510
Capacity	100
Energy consumption	600w

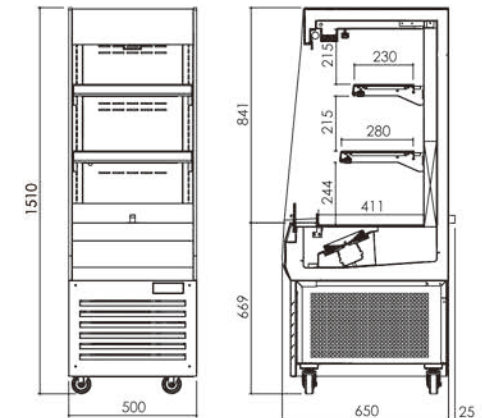

Customizable Options



SUS & Colored Steel



Light colour



Light guide plate



LED lamp

Refrigerators & Freezers

Undercounters & Drawers

Food Prep Tables

Counter Top & Show Cases

Baking-Related Products

Gelato & Icecream Show Cases

OPEN CASES HIGH

R: 5°C~10°C

FAN COOLING

WxDxH (mm)



The model shown in the picture is TOH-1200

	TOH-900	TOH-1200	TOH-1500	TOH-1800
Dimensions	900x700x1910	1200x700x1910	1500x700x1910	1800x700x1910
Capacity	340	470	600	730
Energy consumption	800w	880w	950w	1100w

Customizable Options

- SUS & Colored Steel
- Light colour
- Light guide plate
- LED lamp

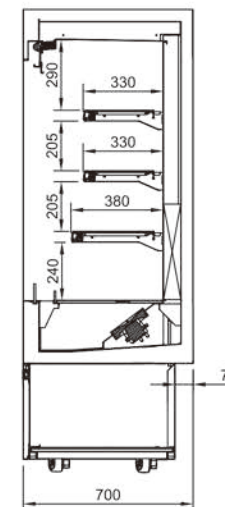
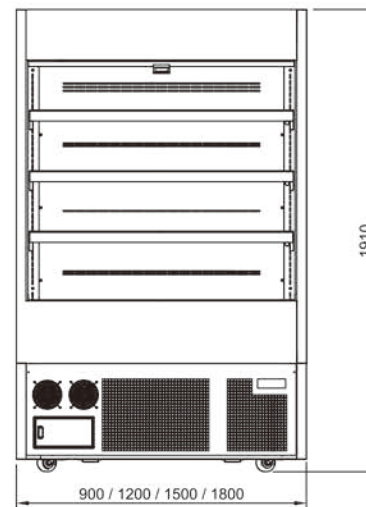

BESPOKE UNIT

R: 5°C~10°C

FAN COOLING

WxDxH (mm)

OPEN ROUND CASES



The model shown in the picture is TBA-900

	TBA-900	TBA-1200	TBA-1500
Dimensions	941x710x1292	1241x710x1292	1541x710x1292
Capacity	150	205	260
Energy consumption	670w	830w	850w

Customizable Options

- SUS & Colored Steel
- Light colour
- Light guide plate
- LED lamp

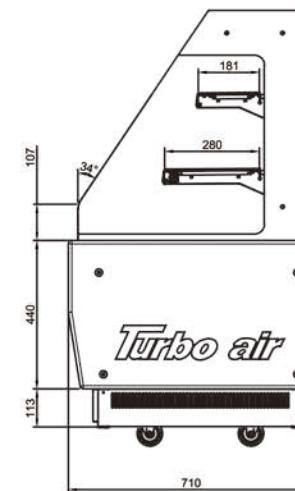
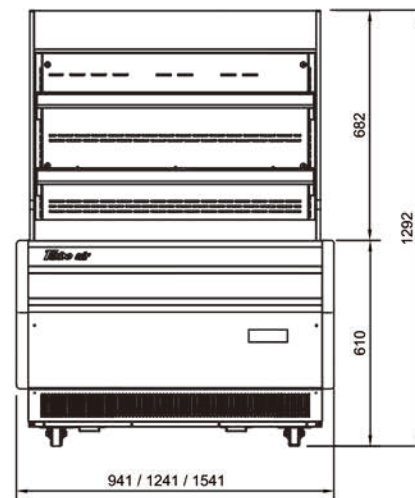

Baking-Related Products

DOUGH FREEZER

- ✓ Designed with dual system.(two compressors, condensers, and evaporators respectively)
- ✓ High Cooling Speed, The temperature can reach as low as -30°C.
- ✓ Self-closing doors with stay open feature; LED interior lighting.
- ✓ Left hinged models available.
- ✓ Radiused corners inside the cabinet are designed for easy-to-clean.

DOUGH CONDITIONER

- ✓ Stylish LCD touch screen.
The interface is easy to understand and convenient to operate.
- ✓ Smart Quick Menu Setting: Menu-presetting function. Pattern memory function.
- ✓ Automatic Humidity Control System (Patented): This function provides the best dough condition, and solve the problem that the humidity can not be adjusted when it's too high.
- ✓ Automatic Drying System.
- ✓ Radiused corners inside the cabinet are designed for easy-to-clean.
- ✓ Self-closing doors with stay open feature; LED interior lighting.



DOUGH FREEZER/DOUGH CONDITIONER

BESPOKE UNIT

FAN COOLING

WxDxH (mm)

* FREEZERS: -18°C ~ -30°C CONDITIONERS: -10°C ~ +45°C

NATURAL Refrigerant

N=(HC)



TBF-36-2R (Freezer)	
Dimensions	800x1230x1970
Capacity	400x2
Energy consumption	1000w



TDC-18-1R (Retarder)	
Dimensions	640x850x1970
Capacity	(18 Pans) 500
Energy consumption	Refrigeration: 540w Dough recovery: 420w



TDC-36-2R (Retarder)	
Dimensions	800x1230x1970
Capacity	(18 x 2 Pans) 400x2
Energy consumption	Refrigeration: 540 Dough recovery: 420

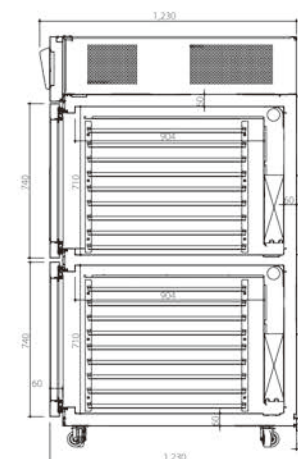
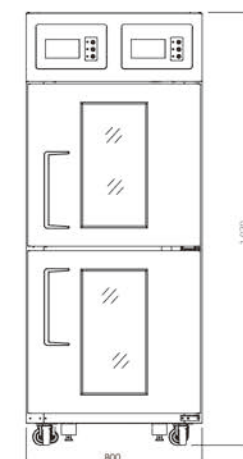
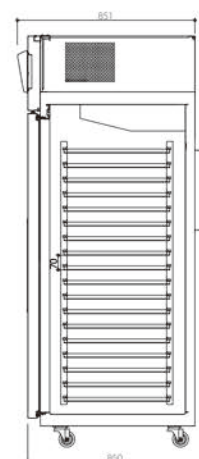
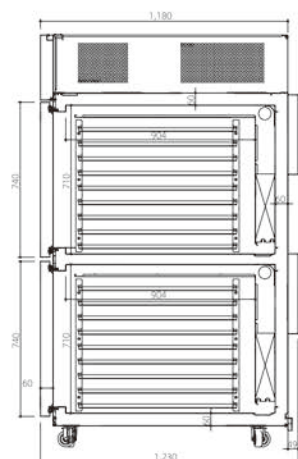
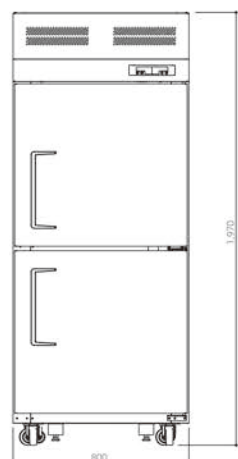

Gelato & Icecream Show Cases



GELATO SHOW CASES

BESPOKE UNIT

F: -16°C~-18°C

FAN COOLING

WxDxH (mm)



	TGC-10	TGC-12
Dimensions	1050x890x1260	1250x890x1260
Capacity	268	362
Energy consumption	950w	1050w

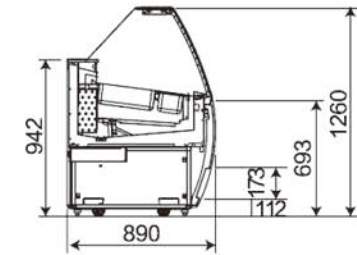

	TGL-10	TGL-12
Dimensions	1050x875x1260	1250x875x1260
Capacity	268	362
Energy consumption	950w	1050w

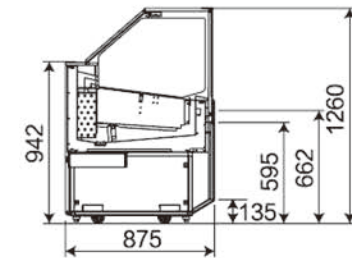

ICE CREAM DIPPING CABINET

F: -16°C~-18°C

FAN COOLING

WxDxH (mm)



TIDC-47W (Freezer)

Dimensions	1192x665x1295
Capacity	250
Energy consumption	400w

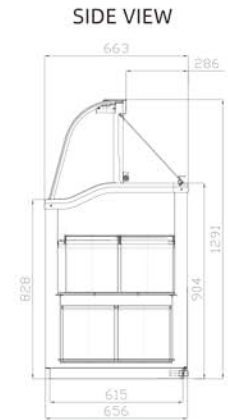
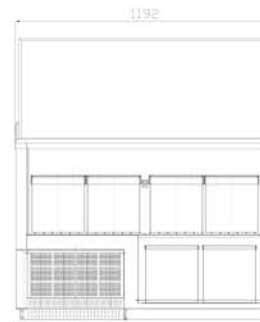
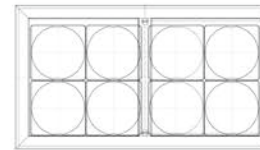

TIDC-91W (Freezer)

Dimensions	2258x665x1295
Capacity	600
Energy consumption	665w

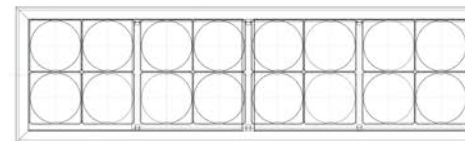

Technical Data Sheet

Reach-In Refrigerators & Freezers / K-Series



Cooling Type Fan Cooling Type



Insulation Type High-density Polyurethane Insulation/Cyclopentane, CFC Free



Temperature Control Type Digital



Voltage 220V 50Hz 1Ph

Product Name	Model	Classification	Ext. DIM(WxDxH mm)	Capacity(L)	Temperature Range	# of Doors	# of Shelves	Refrigerant	Comp (HP)	Full Load Amp.(A)	Power(W)	Weight(Kg)
Reach-in Refrigerators	KR25-1(HC)	Refrigerators	640x860x1926	574	1°C ~ 8°C	1	3	R290	1/3	2.00	300	77
Reach-in Freezers	KF25-1(HC)	Freezers	640x860x1926	574	-21°C ~ -12°C	1	3	R290	2/5	2.50	380	80
Reach-in Refrigerators	KR25-2(HC)	Refrigerators	640x860x1926	572	1°C ~ 8°C	2	3	R290	1/3	2.00	300	77
Reach-in Freezers	KF25-2(HC)	Freezers	640x860x1926	572	-21°C ~ -12°C	2	3	R290	2/5	2.50	380	80
Reach-in Refrigerators	KR45-2(HC)	Refrigerators	1260x860x1926	1215	1°C ~ 8°C	2	6	R290	1/3	2.50	350	142
Reach-in Freezers	KF45-2(HC)	Freezers	1260x860x1926	1215	-21°C ~ -12°C	2	6	R290	1/2	3.50	550	142
Reach-in Refrigerators	KR45-4(HC)	Refrigerators	1260x860x1926	1210	1°C ~ 8°C	4	6	R290	1/3	2.50	350	142
Reach-in Freezers	KF45-4(HC)	Freezers	1260x860x1926	1210	-21°C ~ -12°C	4	6	R290	1/2	3.50	550	142
Reach-in Refrigerators	KR65-3(HC)	Refrigerators	1900x860x1926	1876	1°C ~ 8°C	3	9	R290	1/2	3.00	450	167
Reach-in Freezers	KF65-3(HC)	Freezers	1900x860x1926	1876	-21°C ~ -12°C	3	9	R290	1/2	4.50	750	167
Reach-in Refrigerators	KR65-6(HC)	Refrigerators	1900x860x1926	1868	1°C ~ 8°C	6	9	R290	1/2	3.00	450	167
Reach-in Freezers	KF65-6(HC)	Freezers	1900x860x1926	1868	-21°C ~ -12°C	6	9	R290	1/2	4.50	750	167
Reach-in Dual Temp	KRF25-2(HC)	Dual Temp	640x860x1926	242 / 222	1°C ~ 8°C / -21°C ~ -12°C	2	2	R290	2/5	2.50	350	85
Reach-in Dual Temp	KRF45-2H(HC)	Dual Temp	1260x860x1926	576 / 576	1°C ~ 8°C / -21°C ~ -12°C	2	4	R290	1/3 / 2/5	4.50	600	152
Reach-in Dual Temp	KRF45-4H(HC)	Dual Temp	1260x860x1926	576 / 576	1°C ~ 8°C / -21°C ~ -12°C	4	4	R290	1/3 / 2/5	4.50	600	152
Reach-in Dual Temp	KRF65-3(HC)	Dual Temp	1900x860x1926	575 / 1235	1°C ~ 8°C / -21°C ~ -12°C	3	6	R290	1/3 / 2/5	4.50	700	177
Reach-in Dual Temp	KRF65-6(HC)	Dual Temp	1900x860x1926	575 / 1235	1°C ~ 8°C / -21°C ~ -12°C	6	6	R290	1/3 / 2/5	4.50	700	177
Reach-in Refrigerators Glass door	KR25-1G(HC)	Refrigerators	640x860x1926	574	1°C ~ 8°C	1	3	R290	1/3	2.00	300	87
Reach-in Freezers Glass door	KF25-1G(HC)	Freezers	640x860x1926	574	-21°C ~ -12°C	1	3	R290	1/2	2.50	380	95
Reach-in Refrigerators Glass door	KR25-2G(HC)	Refrigerators	640x860x1926	572	1°C ~ 8°C	2	3	R290	1/3	2.00	300	87
Reach-in Freezers Glass door	KF25-2G(HC)	Freezers	640x860x1926	572	-21°C ~ -12°C	2	3	R290	1/2	2.50	380	95
Reach-in Refrigerators Glass door	KR45-2G(HC)	Refrigerators	1260x860x1926	1215	1°C ~ 8°C	2	6	R290	1/3	2.50	350	152
Reach-in Freezers Glass door	KF45-2G(HC)	Freezers	1260x860x1926	1215	-21°C ~ -12°C	2	6	R290	1/2	3.50	550	170
Reach-in Refrigerators Glass door	KR45-4G(HC)	Refrigerators	1260x860x1926	1210	1°C ~ 8°C	4	6	R290	1/3	2.50	350	152
Reach-in Freezers Glass door	KF45-4G(HC)	Freezers	1260x860x1926	1210	-21°C ~ -12°C	4	6	R290	1/2	3.50	550	170
Reach-in Refrigerators Glass door	KR65-3G(HC)	Refrigerators	1900x860x1926	1876	1°C ~ 8°C	3	9	R290	1/3	3.00	450	177
Reach-in Refrigerators Glass door	KR65-6G(HC)	Refrigerators	1900x860x1926	1868	1°C ~ 8°C	6	9	R290	1/3	3.00	450	177

Technical Data Sheet

Undercounter Refrigerators & Freezers / K-Series



Cooling Type Fan Cooling Type



Insulation Type High-density Polyurethane Insulation/Cyclopentane, CFC Free



Temperature Control Type Digital



Voltage 220V 50Hz 1Ph

Product Name	Model	Classification	Ext. DIM(WxDxH mm)	Capacity(L)	Temperature Range	# of Doors	# of Shelves	Refrigerant	Comp (HP)	Full Load Amp.(A)	Power(W)	Weight(Kg)
Undercounter Refrigerators	KUR9-1(HC)	Refrigerators	900×700×855	198	1℃ ~ 8℃	1	1	R290	1/4	1.40	280	72
Undercounter Freezers	KUF9-1(HC)	Freezers	900×700×855	198	-21℃ ~ -12℃	1	1	R290	2/5	2.50	400	72
Undercounter Refrigerators	KUR12-2(HC)	Refrigerators	1200×700×855	311	1℃ ~ 8℃	2	2	R290	1/4	1.40	280	84
Undercounter Freezers	KUF12-2(HC)	Freezers	1200×700×855	311	-21℃ ~ -12℃	2	2	R290	2/5	2.50	400	84
Undercounter Refrigerators	KUR15-2(HC)	Refrigerators	1500×700×855	425	1℃ ~ 8℃	2	2	R290	1/4	1.40	280	93
Undercounter Freezers	KUF15-2(HC)	Freezers	1500×700×855	425	-21℃ ~ -12℃	2	2	R290	2/5	2.50	400	93
Undercounter Refrigerators	KUR18-3(HC)	Refrigerators	1800×700×855	538	1℃ ~ 8℃	3	3	R290	1/4	1.40	280	109
Undercounter Freezers	KUF18-3(HC)	Freezers	1800×700×855	538	-21℃ ~ -12℃	3	3	R290	3/4	3.50	450	109
Undercounter Freezers	KUR24-4	Refrigerators	2400×700×855	705	1℃ ~ 8℃	4	4	R134a	3/8	3.10	380	145
Undercounter Refrigerators	KUR9-1(600)(HC)	Refrigerators	900×600×855	149	1℃ ~ 8℃	1	1	R290	1/4	1.40	280	61
Undercounter Freezers	KUF9-1(600)(HC)	Freezers	900×600×855	149	-21℃ ~ -12℃	1	1	R290	1/3	2.50	400	61
Undercounter Refrigerators	KUR12-2(600)(HC)	Refrigerators	1200×600×855	234	1℃ ~ 8℃	2	2	R290	1/4	1.40	280	71
Undercounter Freezers	KUF12-2(600)(HC)	Freezers	1200×600×855	234	-21℃ ~ -12℃	2	2	R290	1/3	2.50	400	71
Undercounter Refrigerators	KUR15-2(600)(HC)	Refrigerators	1500×600×855	319	1℃ ~ 8℃	2	2	R290	1/4	1.40	280	79
Undercounter Freezers	KUF15-2(600)(HC)	Freezers	1500×600×855	319	-21℃ ~ -12℃	2	2	R290	1/3	2.50	400	79
Undercounter Refrigerators	KUR18-3(600)(HC)	Refrigerators	1800×600×855	400	1℃ ~ 8℃	3	3	R290	1/4	1.40	280	92
Undercounter Freezers	KUF18-3(600)(HC)	Freezers	1800×600×855	400	-21℃ ~ -12℃	3	3	R290	1/2	3.50	450	92
Undercounter Refrigerators Glass door	KGR9-1(HC)	Refrigerators	900×700×855	198	1℃ ~ 8℃	1	1	R290	1/4	1.40	280	80
Undercounter Refrigerators Glass door	KGR12-2(HC)	Refrigerators	1200×700×855	311	1℃ ~ 8℃	2	2	R290	1/4	1.40	280	96
Undercounter Refrigerators Glass door	KGR15-2(HC)	Refrigerators	1500×700×855	425	1℃ ~ 8℃	2	2	R290	1/4	1.40	280	110
Undercounter Refrigerators Glass door	KGR18-3(HC)	Refrigerators	1800×700×855	538	1℃ ~ 8℃	3	3	R290	1/4	1.40	280	127
Undercounter Refrigerators Glass door	KGR9-1(600)	Refrigerators	900×600×855	149	1℃ ~ 8℃	1	1	R134a	1/3	1.40	314	65
Undercounter Refrigerators Glass door	KGR12-2(600)	Refrigerators	1200×600×855	234	1℃ ~ 8℃	2	2	R134a	1/3	1.40	314	80
Undercounter Refrigerators Glass door	KGR15-2(600)	Refrigerators	1500×600×855	319	1℃ ~ 8℃	2	2	R134a	1/3	1.40	314	90
Undercounter Refrigerators Glass door	KGR18-3(600)	Refrigerators	1800×600×855	400	1℃ ~ 8℃	3	3	R134a	3/8	1.40	390	100
Undercounter Refrigerators Glass door	KGR24-4	Refrigerators	2400×700×855	705	1℃ ~ 8℃	4	4	R290	1/2	3.10	450	195

Technical Data Sheet

Undercounter Refrigerators & Freezers / K-Series



Cooling Type Fan Cooling Type



Insulation Type High-density Polyurethane Insulation/Cyclopentane, CFC Free



Temperature Control Type Digital



Voltage 220V 50Hz 1Ph

Product Name	Model	Classification	Ext. DIM(WxDxH mm)	Capacity(L)	Temperature Range	# of Doors	# of Shelves	Refrigerant	Comp (HP)	Full Load Amp.(A)	Power(W)	Weight(Kg)
Undercounter Dual Temp	KURF12-2(HC)	Dual Temp	1200×700×855	121 / 136	1℃ ~ 8℃ / -21℃ ~ -12℃	2	2	R290	1/3	2.40	400	92
Undercounter Dual Temp	KURF15-2(HC)	Dual Temp	1500×700×855	171 / 191	1℃ ~ 8℃ / -21℃ ~ -12℃	2	2	R290	1/3	2.50	400	101
Undercounter Dual Temp	KURF18-3(HC)	Dual Temp	1800×700×855	151 / 287	1℃ ~ 8℃ / -21℃ ~ -12℃	3	3	R290	2/5	2.50	400	120
Undercounter Refrigerators Drawers	KUR9-2D-2(HC)	Refrigerators	900×700×855	198	1℃ ~ 8℃			R290	1/4	1.40	280	84
Undercounter Freezers Drawers	KUF9-2D-2(HC)	Freezers	900×700×855	198	-21℃ ~ -12℃			R290	2/5	2.50	400	84
Undercounter Refrigerators Drawers	KUR12-2D-2(HC)	Refrigerators	1200×700×855	311	1℃ ~ 8℃	1	1	R290	1/4	1.40	280	97
Undercounter Freezers Drawers	KUF12-2D-2(HC)	Freezers	1200×700×855	311	-21℃ ~ -12℃	1	1	R290	2/5	2.50	400	97
Undercounter Refrigerators Drawers	KUR12-2D-4(HC)	Refrigerators	1200×700×855	311	1℃ ~ 8℃			R290	1/4	1.40	280	97
Undercounter Freezers Drawers	KUF12-2D-4(HC)	Freezers	1200×700×855	311	-21℃ ~ -12℃			R290	2/5	2.50	400	97
Undercounter Refrigerators Drawers	KUR18-2D-2(HC)	Refrigerators	1800×700×855	425	1℃ ~ 8℃	2	2	R290	1/4	1.40	280	107
Undercounter Refrigerators Drawers	KUR18-2D-4(HC)	Refrigerators	1800×700×855	425	1℃ ~ 8℃	1	1	R290	1/4	1.40	280	107
Undercounter Refrigerators Drawers	KUR18-2D-6(HC)	Refrigerators	1800×700×855	425	1℃ ~ 8℃			R290	1/4	1.40	280	107
Undercounter Refrigerators Drawers	KUR9-3D-3(HC)	Refrigerators	900×700×855	198	1℃ ~ 8℃			R290	1/4	1.40	280	84
Undercounter Freezers Drawers	KUF9-3D-3(HC)	Freezers	900×700×855	198	-21℃ ~ -12℃			R290	2/5	2.50	400	84
Undercounter Refrigerators Drawers	KUR12-3D-3(HC)	Refrigerators	1200×700×855	311	1℃ ~ 8℃	1	1	R290	1/4	1.40	280	97
Undercounter Freezers Drawers	KUF12-3D-3(HC)	Freezers	1200×700×855	311	-21℃ ~ -12℃	1	1	R290	2/5	2.50	400	97
Undercounter Refrigerators Drawers	KUR12-3D-6(HC)	Refrigerators	1200×700×855	311	1℃ ~ 8℃			R290	1/4	1.40	280	97
Undercounter Freezers Drawers	KUF12-3D-6(HC)	Freezers	1200×700×855	311	-21℃ ~ -12℃			R290	2/5	2.50	400	97
Undercounter Refrigerators Drawers	KUR18-3D-3(HC)	Refrigerators	1800×700×855	425	1℃ ~ 8℃	2	2	R290	1/4	1.40	280	107
Undercounter Refrigerators Drawers	KUR18-3D-6(HC)	Refrigerators	1800×700×855	425	1℃ ~ 8℃	1	1	R290	1/4	1.40	280	107
Undercounter Refrigerators Drawers	KUR18-3D-9(HC)	Refrigerators	1800×700×855	425	1℃ ~ 8℃			R290	1/4	1.40	280	107

Technical Data Sheet

Food Prep Tables / Salad Prep Tables

 Cooling Type Fan Cooling Type
  Insulation Type High-density Polyurethane Insulation/Cyclopentane, CFC Free
  Temperature Control Type Digital
  Voltage 220V 50Hz 1Ph

Product Name	Model	Classification	Ext. DIM(WxDxH mm)	Capacity(L)	Temperature Range	# of Doors	# of Shelves	Refrigerant	Comp (HP)	Full Load Amp.(A)	Power(W)	Weight(Kg)
Salad Prep Tables	KSR9-1	Refrigerators	900×700×855	213	1°C ~ 8°C	1	1	R134a	3/8	1.40	314	70
Salad Prep Tables	KSR12-2	Refrigerators	1200×700×855	309	1°C ~ 8°C	2	2	R134a	3/8	1.40	314	82
Salad Prep Tables	KSR15-2	Refrigerators	1500×700×855	420	1°C ~ 8°C	2	2	R134a	3/8	1.40	314	91
Salad Prep Tables	KSR18-3	Refrigerators	1800×700×855	516	1°C ~ 8°C	3	3	R134a	3/8	1.40	366	107
Salad Prep Tables	KSR24-4	Refrigerators	2400×700×855	690	1°C ~ 8°C	4	4	R134a	1/2	3.10	390	165
Salad Prep Tables (Hood Lid)	KHR9-1	Refrigerators	900×700×855	213	1°C ~ 8°C	1	1	R134a	3/8	1.40	314	75
Salad Prep Tables (Hood Lid)	KHR12-2	Refrigerators	1200×700×855	309	1°C ~ 8°C	2	2	R134a	3/8	1.40	314	89
Salad Prep Tables (Hood Lid)	KHR15-2	Refrigerators	1500×700×855	420	1°C ~ 8°C	2	2	R134a	3/8	1.40	314	100
Salad Prep Tables (Hood Lid)	KHR18-3	Refrigerators	1800×700×855	516	1°C ~ 8°C	3	3	R134a	3/8	1.40	366	120

Food Prep Tables / Pizza Prep Tables

 Cooling Type Fan Cooling Type
  Insulation Type High-density Polyurethane Insulation/Cyclopentane, CFC Free
  Temperature Control Type Digital
  Voltage 220V 50Hz 1Ph

Product Name	Model	Classification	Ext. DIM(WxDxH mm)	Capacity(L)	Temperature Range	# of Doors	# of Shelves	Refrigerant	Comp (HP)	Full Load Amp.(A)	Power(W)	Weight(Kg)
Pizza Prep Tables	CTPR-44SD	Refrigerators	1117×820×1069	396	1°C ~ 8°C	1	2	R134a	1/4	2.50	396	140
Pizza Prep Tables	CTPR-44-D2	Refrigerators	1117×820×1069	396	1°C ~ 8°C			R134a	1/4	2.50	566	140
Pizza Prep Tables	CTPR-67SD	Refrigerators	1702×820×1069	566	1°C ~ 8°C	2	4	R134a	1/2	2.50	878	187
Pizza Prep Tables	CTPR-67-D4	Refrigerators	1702×820×1069	566	1°C ~ 8°C			R134a	1/2	2.50	878	187
Pizza Prep Tables	CTPR-93SD	Refrigerators	2362×820×1069	878	1°C ~ 8°C	3	6	R134a	1/2	3.10	878	262

Food Prep Tables / Chef Base Refrigerators

 Cooling Type Fan Cooling Type
  Insulation Type High-density Polyurethane Insulation/Cyclopentane, CFC Free
  Temperature Control Type Digital
  Voltage 220V 50Hz 1Ph

Product Name	Model	Classification	Ext. DIM(WxDxH mm)	Capacity(L)	Temperature Range	# of Doors	# of Shelves	Refrigerant	Comp (HP)	Full Load Amp.(A)	Power(W)	Weight(Kg)
Chef Base Refrigerators	TCBE-52SDR	Refrigerators	1328×815×522	311	1°C ~ 8°C			R134a	1/3	3.60	311	110
Chef Base Refrigerators	TCBE-82SDR	Refrigerators	2123×815×522	538	1°C ~ 8°C			R134a	1/3	5.20	538	186
Chef Base Refrigerators	TCBE-96SDR	Refrigerators	2447×815×522	651	1°C ~ 8°C			R134a	1/3	5.50	651	219
Chef Base Refrigerators	KUC12-2	Refrigerators	1200×700×590	190	0°C ~ 7°C			R134a	1/6	1.20	240	86
Chef Base Refrigerators	KUC15-2	Refrigerators	1500×700×590	260	0°C ~ 7°C			R134a	1/4	1.80	343	125
Chef Base Refrigerators	KUC18-4	Refrigerators	1800×700×590	325	0°C ~ 7°C			R134a	1/4	1.90	350	168

Technical Data Sheet

Glass Door Merchandisers / FRS

 Cooling Type Fan Cooling Type
  Insulation Type High-density Polyurethane Insulation/Cyclopentane, CFC Free
  Temperature Control Type Digital
  Voltage 220V 50Hz 1Ph

Product Name	Model	Classification	Ext. DIM(WxDxH mm)	Capacity(L)	Temperature Range	# of Doors	# of Shelves	Refrigerant	Comp (HP)	Full Load Amp.(A)	Power(W)	Weight(Kg)
Glass Door Merchandisers	FRS-600RP	Refrigerators	732x702x2092	602	0°C ~ 8°C	1	4	R134a	1/6	1.30	260	104
Glass Door Merchandisers	FRS-1350RS	Refrigerators	1417x813x2119	1315	0°C ~ 8°C	2	8	R404A	1/2	4.80	905	226
Glass Door Merchandisers	FRS-650F	Refrigerators	686x756x2108	651	-27°C ~ -15°C	1	4	R404A	3/4	5.00	1057	171
Glass Door Merchandisers	FRS-1250F	Refrigerators	1382x756x2108	1220	-27°C ~ -15°C	2	8	R404A	1 1/3	6.37	1400	270

Glass Door Merchandisers / Back Bar

 Cooling Type Fan Cooling Type
  Insulation Type High-density Polyurethane Insulation/Cyclopentane, CFC Free
  Temperature Control Type Digital
  Voltage 220V 50Hz 1Ph

Product Name	Model	Classification	Ext. DIM(WxDxH mm)	Capacity(L)	Temperature Range	# of Doors	# of Shelves	Refrigerant	Comp (HP)	Full Load Amp.(A)	Power(W)	Weight(Kg)
Back Bar Refrigerators	TB6-8H-SWB	Refrigerators	600x550x800	100	1°C ~ 7°C	1	1	R134a	1/6	1.20	229	55
Back Bar Refrigerators	TB6-8H-SWS	Refrigerators	600x550x800	100	1°C ~ 7°C	1	1	R134a	1/6	1.20	229	55
Back Bar Refrigerators	TB6-9H-SWB	Refrigerators	600x550x900	116	1°C ~ 7°C	1	1	R134a	1/6	1.20	229	64
Back Bar Refrigerators	TB6-9H-SWS	Refrigerators	600x550x900	116	1°C ~ 7°C	1	1	R134a	1/6	1.20	229	64
Back Bar Refrigerators	TB9-8H-SWB	Refrigerators	900x550x800	157	1°C ~ 7°C	2	2	R134a	1/6	1.20	255	80
Back Bar Refrigerators	TB9-8H-SWS	Refrigerators	900x550x800	157	1°C ~ 7°C	2	2	R134a	1/6	1.20	255	80
Back Bar Refrigerators	TB9-9H-SWB	Refrigerators	900x550x900	182	1°C ~ 7°C	2	2	R134a	1/6	1.20	255	85
Back Bar Refrigerators	TB9-9H-SWS	Refrigerators	900x550x900	182	1°C ~ 7°C	2	2	R134a	1/6	1.20	255	85
Back Bar Refrigerators	TB13-8H-SWB	Refrigerators	1352x550x800	246	1°C ~ 7°C	3	3	R134a	1/6	1.40	288	95
Back Bar Refrigerators	TB13-8H-SWS	Refrigerators	1352x550x800	246	1°C ~ 7°C	3	3	R134a	1/6	1.40	288	95
Back Bar Refrigerators	TB13-9H-SWB	Refrigerators	1352x550x900	285	1°C ~ 7°C	3	3	R134a	1/6	1.40	288	109
Back Bar Refrigerators	TB13-9H-SWS	Refrigerators	1352x550x900	285	1°C ~ 7°C	3	3	R134a	1/6	1.40	288	109
Back Bar Refrigerators	TBB-2SGD	Refrigerators	1494x692x1027	580	0°C ~ 10°C	2	4	R134a	1/5	1.40	288	140
Back Bar Refrigerators	TBB-4SGD	Refrigerators	2294x692x1066	940	0°C ~ 10°C	3	6	R134a	1/3	2.40	461	237

Technical Data Sheet

Food Prep Tables / Rectangle Bakery Cases

 Cooling Type Fan Cooling Type
  Insulation Type High-density Polyurethane Insulation/Cyclopentane, CFC Free
  Temperature Control Type Digital
  Voltage 220V 50Hz 1Ph

Product Name	Model	Classification	Ext. DIM(WxDxH mm)	Capacity(L)	Temperature Range	# of Doors	# of Shelves	Refrigerant	Comp (HP)	Full Load Amp.(A)	Power(W)	Weight(Kg)
Rectangle Bakery Cases	TBP900-1	Refrigerators	900x700x1170	255	3°C ~ 8°C	Sliding Door	1 (2 Layer)	R404A	3/4	3.50	620	175
Rectangle Bakery Cases	TBP1200-1	Refrigerators	1200x700x1170	345	3°C ~ 8°C	Sliding Door	1 (2 Layer)	R404A	3/4	3.80	670	225
Rectangle Bakery Cases	TBP1500-1	Refrigerators	1500x700x1170	440	3°C ~ 8°C	Sliding Door	1 (2 Layer)	R404A	3/4	4.40	830	265
Rectangle Bakery Cases	TBP1800-1	Refrigerators	1800x700x1170	530	3°C ~ 8°C	Sliding Door	1 (2 Layer)	R404A	3/4	4.80	850	280
Rectangle Bakery Cases	TBP2100-1	Refrigerators	2100x700x1170	620	3°C ~ 8°C	Sliding Door	1 (2 Layer)	R404A	1	5.00	880	300
Rectangle Bakery Cases	TBP2400-1	Refrigerators	2400x700x1170	710	3°C ~ 8°C	Sliding Door	1 (2 Layer)	R404A	1	5.20	920	330
Rectangle Bakery Cases	TBP900-2	Refrigerators	900x700x1370	355	3°C ~ 8°C	Sliding Door	2 (3 Layer)	R404A	3/4	3.80	670	180
Rectangle Bakery Cases	TBP1200-2	Refrigerators	1200x700x1370	485	3°C ~ 8°C	Sliding Door	2 (3 Layer)	R404A	3/4	4.40	830	230
Rectangle Bakery Cases	TBP1500-2	Refrigerators	1500x700x1370	615	3°C ~ 8°C	Sliding Door	2 (3 Layer)	R404A	3/4	4.80	850	270
Rectangle Bakery Cases	TBP1800-2	Refrigerators	1800x700x1370	740	3°C ~ 8°C	Sliding Door	2 (3 Layer)	R404A	3/4	5.00	880	290
Rectangle Bakery Cases	TBP2100-2	Refrigerators	2100x700x1370	870	3°C ~ 8°C	Sliding Door	2 (3 Layer)	R404A	1	5.20	920	310
Rectangle Bakery Cases	TBP2400-2	Refrigerators	2400x700x1370	1000	3°C ~ 8°C	Sliding Door	2 (3 Layer)	R404A	1	5.50	970	340
Rectangle Bakery Cases	TBP900-3	Refrigerators	900x700x1570	455	3°C ~ 8°C	Sliding Door	2 (3 Layer)	R404A	3/4	4.40	830	185
Rectangle Bakery Cases	TBP1200-3	Refrigerators	1200x700x1570	620	3°C ~ 8°C	Sliding Door	2 (3 Layer)	R404A	3/4	4.80	860	235
Rectangle Bakery Cases	TBP1500-3	Refrigerators	1500x700x1570	785	3°C ~ 8°C	Sliding Door	2 (3 Layer)	R404A	3/4	5.00	880	275
Rectangle Bakery Cases	TBP1800-3	Refrigerators	1800x700x1570	950	3°C ~ 8°C	Sliding Door	2 (3 Layer)	R404A	3/4	5.20	920	300
Rectangle Bakery Cases	TBP2100-3	Refrigerators	2100x700x1570	1115	3°C ~ 8°C	Sliding Door	2 (3 Layer)	R404A	1	5.50	970	320
Rectangle Bakery Cases	TBP2400-3	Refrigerators	2400x700x1570	1280	3°C ~ 8°C	Sliding Door	2 (3 Layer)	R404A	1	6.00	1060	350

Counter Top / Sushi Cases

 Cooling Type Fan Cooling Type
  Insulation Type High-density Polyurethane Insulation/Cyclopentane, CFC Free
  Temperature Control Type Digital
  Voltage 220V 50Hz 1Ph

Product Name	Model	Classification	Ext. DIM(WxDxH mm)	Capacity(L)	Temperature Range	# of Doors	# of Shelves	Refrigerant	Comp (HP)	Full Load Amp.(A)	Power(W)	Weight(Kg)
Sushi Cases	CTST-1200	Refrigerators	1200x335x225	1/4 GN pans x 5	0°C ~ 7°C			R134a	1/6	1.10	150	25
Sushi Cases	CTST-1500	Refrigerators	1500x335x225	1/4 GN pans x 7	0°C ~ 7°C			R134a	1/6	1.10	150	30
Sushi Cases	CTST-1800	Refrigerators	1800x335x225	1/4 GN pans x 9	0°C ~ 7°C			R134a	1/6	1.10	150	35
Sushi Cases	CTST-1200G	Refrigerators	1200x335x425	1/4 GN pans x 5	0°C ~ 7°C			R134a	1/6	1.10	150	25
Sushi Cases	CTST-1500G	Refrigerators	1500x335x425	1/4 GN pans x 7	0°C ~ 7°C			R134a	1/6	1.10	150	30
Sushi Cases	CTST-1800G	Refrigerators	1800x335x425	1/4 GN pans x 9	0°C ~ 7°C			R134a	1/6	1.10	150	35

Technical Data Sheet

Show Cases / Round Bakery · High Bakery · Combi Show Cases

 Cooling Type Fan Cooling Type  Insulation Type High-density Polyurethane Insulation/Cyclopentane, CFC Free  Temperature Control Type Digital  Voltage 220V 50Hz 1Ph

Product Name	Model	Classification	Ext. DIM(WxDxH mm)	Capacity(L)	Temperature Range	# of Doors	# of Shelves	Refrigerant	Comp (HP)	Full Load Amp.(A)	Power(W)	Weight(Kg)
Round Bakery Cases	TBR900-2	Refrigerators	900×700×1370	335	3°C ~ 8°C	Sliding Door	2 (3 Layer)	R404A	3/4	4.00	670	180
Round Bakery Cases	TBR1200-2	Refrigerators	1200×700×1370	485	3°C ~ 8°C	Sliding Door	2 (3 Layer)	R404A	3/4	4.50	830	230
Round Bakery Cases	TBR1500-2	Refrigerators	1500×700×1370	615	3°C ~ 8°C	Sliding Door	2 (3 Layer)	R404A	3/4	4.50	850	270
Round Bakery Cases	TBR1800-2	Refrigerators	1800×700×1370	740	3°C ~ 8°C	Sliding Door	2 (3 Layer)	R404A	3/4	5.00	880	290
Bakery Cases High	TBH-900	Refrigerators	900×700×1910	340	3°C ~ 8°C	Sliding Door	3 (4 Layer)	R404A	1/2	4.00	800	200
Bakery Cases High	TBH-1200	Refrigerators	1200×700×1910	470	3°C ~ 8°C	Sliding Door	3 (4 Layer)	R404A	1/2	4.50	880	260
Bakery Cases High	TBH-1500	Refrigerators	1500×700×1910	600	3°C ~ 8°C	Sliding Door	3 (4 Layer)	R404A	1/2	4.50	950	340
Bakery Cases High	TBH-1800	Refrigerators	1800×700×1910	725	3°C ~ 8°C	Sliding Door	3 (4 Layer)	R404A	1/2	5.00	1000	380
Combi Show Cases	TCB-1500	Refrigerators	1500×900×1510	Bakery 117 / Open 256	Bakery 3-8 / Open 5-10	Sliding Door	1 (2 Layer)	R404A	R404A	6.70	1250	300
Combi Show Cases	TCB-1800	Refrigerators	1800×900×1510	Bakery 142 / Open 311	Bakery 3-8 / Open 5-10	Sliding Door	1 (2 Layer)	R404A	R404A	7.90	1500	400

Show Cases / Chocolate Cases

 Cooling Type Fan Cooling Type  Insulation Type High-density Polyurethane Insulation/Cyclopentane, CFC Free  Temperature Control Type Digital  Voltage 220V 50Hz 1Ph

Product Name	Model	Classification	Ext. DIM(WxDxH mm)	Capacity(L)	Temperature Range	# of Doors	# of Shelves	Refrigerant	Comp (HP)	Full Load Amp.(A)	Power(W)	Weight(Kg)
Chocolate Cases	TCD-900	Refrigerators	900×800×1060	211	Show 5~8 / Store 10~14 (Humidity 50±5%)	2 Sliding Door		R404A	3/4	4.50	800	200
Chocolate Cases	TCD-1200	Refrigerators	1200×800×1060	288	Show 5~8 / Store 10~14 (Humidity 50±5%)	2 Sliding Door		R404A	3/4	5.10	900	225
Chocolate Cases	TCD-1500	Refrigerators	1500×800×1060	345	Show 5~8 / Store 10~14 (Humidity 50±5%)	2 Sliding Door		R404A	1	5.50	970	250
Chocolate Cases	TCD-1800	Refrigerators	1800×800×1060	410	Show 5~8 / Store 10~14 (Humidity 50±5%)	2 Sliding Door		R404A	1	6.10	1080	300
Chocolate Cases	TCD-2100	Refrigerators	2100×800×1060	475	Show 5~8 / Store 10~14 (Humidity 50±5%)	2 Sliding Door		R404A	1	7.40	1150	350

Show Cases / Open Cases Slim · High · Round

 Cooling Type Fan Cooling Type  Insulation Type High-density Polyurethane Insulation/Cyclopentane, CFC Free  Temperature Control Type Digital  Voltage 220V 50Hz 1Ph

Product Name	Model	Classification	Ext. DIM(WxDxH mm)	Capacity(L)	Temperature Range	# of Doors	# of Shelves	Refrigerant	Comp (HP)	Full Load Amp.(A)	Power(W)	Weight(Kg)
Open Cases Slim	TOM500-2	Refrigerators	500×650×1510	100	5°C ~ 10°C		2 (3 Layer)	R404A	3/4	3.00	600	130
Open Cases Slim	TOM500-4	Refrigerators	500×650×1910	140	5°C ~ 10°C		4 (5 Layer)	R404A	3/4	3.20	625	160
Open Cases High	TOH-900	Refrigerators	900×700×1910	340	5°C ~ 10°C		3 (4 Layer)	R404A	1/2	4.60	800	175
Open Cases High	TOH-120	Refrigerators	1200×700×1910	470	5°C ~ 10°C		3 (4 Layer)	R404A	1/2	5.00	880	215
Open Cases High	TOH-1500	Refrigerators	1500×700×1910	600	5°C ~ 10°C		3 (4 Layer)	R404A	1/2	5.00	950	253
Open Cases High	TOH-1800	Refrigerators	1800×700×1910	730	5°C ~ 10°C		3 (4 Layer)	R404A	1/2	6.70	1100	310
Open Round Cases	TBA-900	Refrigerators	941×710×1292	150	5°C ~ 10°C		2 (3 Layer)	R404A	3/4	3.60	670	170
Open Round Cases	TBA-1200	Refrigerators	1241×710×1292	205	5°C ~ 10°C		2 (3 Layer)	R404A	3/4	4.50	830	220
Open Round Cases	TBA-1500	Refrigerators	1541×710×1292	260	5°C ~ 10°C		2 (3 Layer)	R404A	3/4	5.00	850	260

Technical Data Sheet

Food Prep Tables / Sandwich Cases



Cooling Type Fan Cooling Type



Insulation Type High-density Polyurethane Insulation/Cyclopentane, CFC Free



Temperature Control Type Digital



Voltage 220V 50Hz 1Ph

Product Name	Model	Classification	Ext. DIM(WxDxH mm)	Capacity(L)	Temperature Range	# of Doors	# of Shelves	Refrigerant	Comp (HP)	Full Load Amp.(A)	Power(W)	Weight(Kg)
Sandwich Cases	TOS-900	Refrigerators	900×900×840/920	100 / 145	5°C ~ 10°C			R404A	3/4	2.00	400	140
Sandwich Cases	TOS-1200	Refrigerators	1200×900×840/920	135 / 200	5°C ~ 10°C			R404A	3/4	2.50	500	170
Sandwich Cases	TOS-1500	Refrigerators	1500×900×840/920	170 / 255	5°C ~ 10°C			R404A	3/4	3.00	600	200
Sandwich Cases	TOS-1800	Refrigerators	1800×900×840/920	205 / 310	5°C ~ 10°C			R404A	3/4	3.50	705	230
Sandwich Cases	TOS-2100	Refrigerators	2100×900×840/920	240 / 365	5°C ~ 10°C			R404A	3/4	4.50	820	255
Sandwich Cases	TOS-2400	Refrigerators	2400×900×840/920	275 / 420	5°C ~ 10°C			R404A	3/4	5.60	910	275
Sandwich Cases	TOS-900A	Refrigerators	900×900×920	123	5°C ~ 10°C			R404A	3/4	2.00	400	145
Sandwich Cases	TOS-1200A	Refrigerators	1200×900×920	168	5°C ~ 10°C			R404A	3/4	2.50	500	176
Sandwich Cases	TOS-1500A	Refrigerators	1500×900×920	212	5°C ~ 10°C			R404A	3/4	3.00	600	210
Sandwich Cases	TOS-1800A	Refrigerators	1800×900×920	257	5°C ~ 10°C			R404A	3/4	3.50	705	240
Sandwich Cases	TOS-900P	Refrigerators	900×900×920	164	5°C ~ 10°C			R404A	3/4	2.00	400	140
Sandwich Cases	TOS-1200P	Refrigerators	1200×900×920	226	5°C ~ 10°C			R404A	3/4	2.50	500	170
Sandwich Cases	TOS-1500P	Refrigerators	1500×900×920	289	5°C ~ 10°C			R404A	3/4	3.00	600	200
Sandwich Cases	TOS-1800P	Refrigerators	1800×900×920	352	5°C ~ 10°C			R404A	3/4	3.50	705	230
Sandwich Cases	TOS-2100P	Refrigerators	2100×900×920	415	5°C ~ 10°C			R404A	3/4	4.50	820	255
Sandwich Cases	TOS-900C	Refrigerators	900×900×1055	110	5°C ~ 10°C			R404A	3/4	2.00	400	140
Sandwich Cases	TOS-1200C	Refrigerators	1200×900×1055	150	5°C ~ 10°C			R404A	3/4	2.50	500	170
Sandwich Cases	TOS-1500C	Refrigerators	1500×900×1055	180	5°C ~ 10°C			R404A	3/4	3.00	600	200
Sandwich Cases	TOS-1800C	Refrigerators	1800×900×1055	200	5°C ~ 10°C			R404A	3/4	3.50	705	230
Sandwich Cases	TOS-900R	Refrigerators	900×900×920	123	5°C ~ 10°C			R404A	3/4	2.00	400	143
Sandwich Cases	TOS-1200R	Refrigerators	1200×900×920	168	5°C ~ 10°C			R404A	3/4	2.50	500	173
Sandwich Cases	TOS-1500R	Refrigerators	1500×900×920	212	5°C ~ 10°C			R404A	3/4	3.00	600	207
Sandwich Cases	TOS-1800R	Refrigerators	1800×900×920	257	5°C ~ 10°C			R404A	3/4	3.50	705	237
Sandwich Cases	TBS-900F	Refrigerators	900×900×1158	230	5°C ~ 10°C			R404A	3/4	4.00	400	155
Sandwich Cases	TBS-1200F	Refrigerators	1200×900×1158	315	5°C ~ 10°C			R404A	3/4	4.50	500	175
Sandwich Cases	TBS-1500F	Refrigerators	1500×900×1158	395	5°C ~ 10°C			R404A	3/4	4.90	600	200
Sandwich Cases	TBS-1800F	Refrigerators	1800×900×1158	480	5°C ~ 10°C			R404A	3/4	5.50	705	230

Technical Data Sheet

Baking Related Products / Dough Freezer · Conditioner

 Cooling Type Fan Cooling Type
  Insulation Type High-density Polyurethane Insulation/Cyclopentane, CFC Free
  Temperature Control Type Digital
  Voltage 220V 50Hz 1Ph

Product Name	Model	Classification	Ext. DIM(WxDxH mm)	Capacity(L)	Temperature Range	# of Doors	# of Shelves	Refrigerant	Comp (HP)	Full Load Amp.(A)	Power(W)	Weight(Kg)
Dough Freezers	TBF-36-2R	Freezers	800x1230x1970	400x2	-30°C ~ -18°C	2	36	R404A	3/4	6.80	1000	245
Dough Conditioners	TDC-18-1R	Dough Conditioners	640x850x1970	500	-10°C ~ 45°C (Humidity 30%~90%)	1	18	R404A	3/4	Refrigeration:3.5 Dough recovery:1.9	Refrigeration:540 Dough recovery:420	180
Dough Conditioners	TDC-36-2R	Dough Conditioners	800x1230x1970	400x2	-10°C ~ 45°C (Humidity 30%~90%)	2	36	R404A	3/4	Refrigeration:3.5 Dough recovery:1.9	Refrigeration:540 Dough recovery:420	250

Show Cases / Gelato · Icecream Show Cases

 Cooling Type Fan Cooling Type
  Insulation Type High-density Polyurethane Insulation/Cyclopentane, CFC Free
  Temperature Control Type Digital
  Voltage 220V 50Hz 1Ph

Product Name	Model	Classification	Ext. DIM(WxDxH mm)	Capacity(L)	Temperature Range	# of Doors	# of Shelves	Refrigerant	Comp (HP)	Full Load Amp.(A)	Power(W)	Weight(Kg)
Gelato Show Cases	TGC-10	Freezers	1050x890x1260	268	-18°C ~ -16°C	Sliding Door		R404A		6.00	950	270
Gelato Show Cases	TGC-12	Freezers	1250x890x1260	362	-18°C ~ -16°C	Sliding Door		R404A		8.00	1050	330
Gelato Show Cases	TGL-10	Freezers	1050x875x1260	268	-18°C ~ -16°C	Sliding Door		R404A		6.00	950	270
Gelato Show Cases	TGL-12	Freezers	1250x875x1260	368	-18°C ~ -16°C	Sliding Door		R404A		8.00	1050	330
Icecream Dipping Cabinet	TIDC-47W	Freezers	1192x665x1295	250	-23°C ~ -13°C	Sliding Door	4	R404A	1/2	2.80	400	170
Icecream Dipping Cabinet	TIDC-91W	Freezers	2258x665x1295	600	-23°C ~ -13°C	Sliding Door	4	R404A	1	3.50	665	250

REFRIGERATOR MANUFACTURER
Turbo air

www.turboairinc.com.au

1300 820006

SYDNEY

ADD: 10 Highgate St.

Auburn NSW 2144

TEL: 1300 820006

Email: TA.Admin@turboairinc.com.au

MELBOURNE

ADD: 62 Parkhurst Drive

Knoxfield VIC 3180

TEL: 1300 820006

Email: TA.Admin@turboairinc.com.au

BRISBANE

ADD: 21 Darnick St

Underwood QLD 4119

TEL: 1300 820006

Email: sales@turboairqld.com.au

SYDNEY

ADD: 10 Highgate St.
Auburn NSW 2144

TEL: 1300 820006

Email: TA.Admin@turboairinc.com.au

MELBOURNE

ADD: 62 Parkhurst Drive
Knoxfield VIC 3180

TEL: 1300 820006

Email: TA.Admin@turboairinc.com.au

BRISBANE

ADD: 21 Darnick St
Underwood QLD 4119

TEL: 1300 820006

Email: sales@turboairqld.com.au